

S W I S S
M B M

1704

**Ersatzteile
Zubehör**

**Spare parts
Accessories**

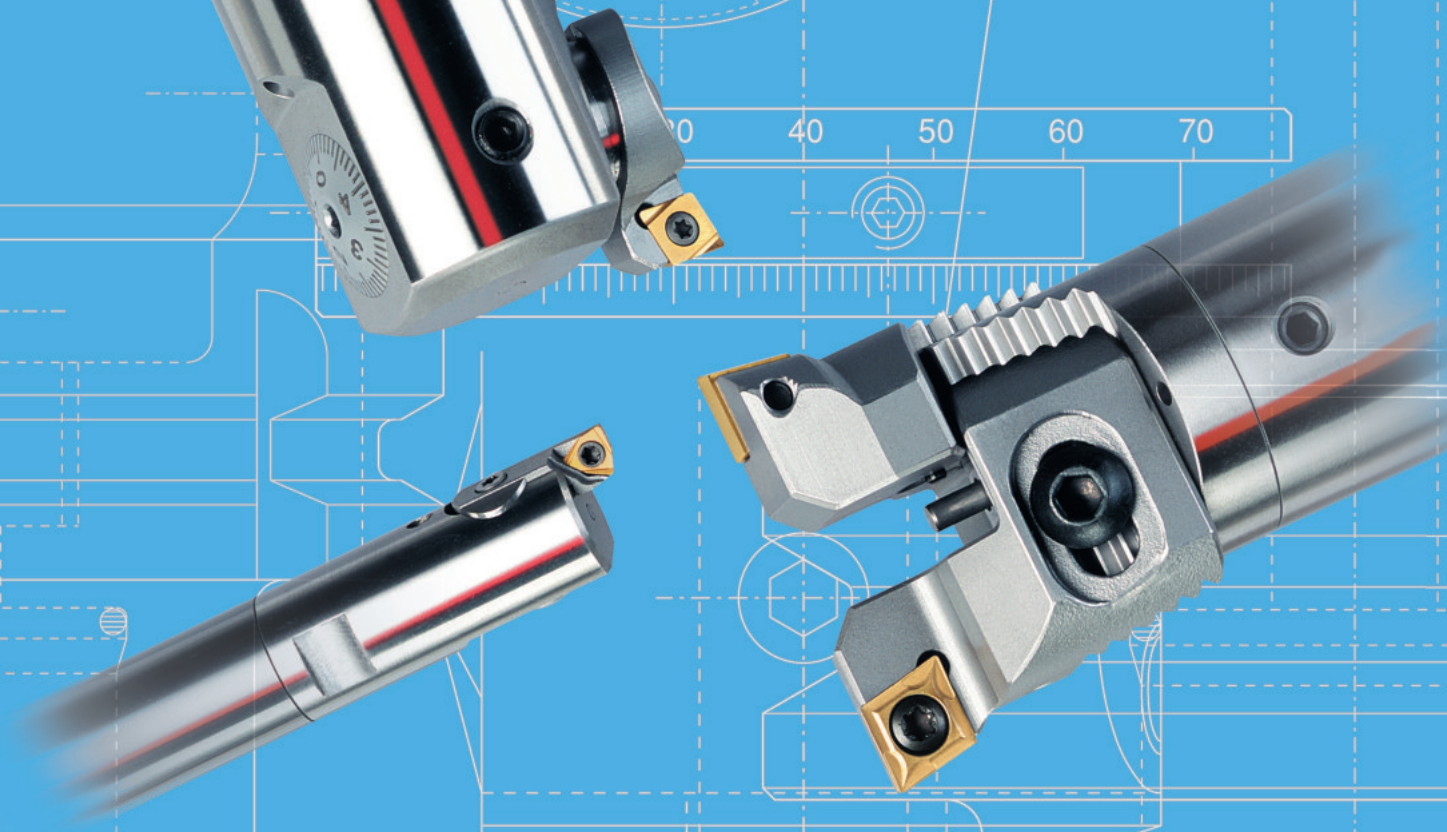

Inhaltsverzeichnis / Table of contents

	Typ / Type	Ersatzteilliste / Spare part list Seite / Page	Bedienungsanleitung / Instruction manual Seite / Page
Ausdrehkopf / Fine boring head	262/263 MICRO HEAD	3	15
	262/266/269	3	15
	267 VARIO HEAD	3	16
	261 MULTI HAED	3	16
Auswuchtring / Balancing ring	264	4	21
Ausdrehstahlverlängerung / Boring bar extension	268	4	
Ausdrehstahl / Boring Bar	272	4	
	271	4	
	274	4	
	278	5	18
Feinbohrkopf / Fine boring head	280/281	5	18
	251/252/	6	18
Anzeigeeinheit / Display unit	266	6	19
Wendeplattenhalter / Insert holder	254/282	7	
Umkehradapter / Reversal adapter	255	7	
Zweischneiderkopf / Twin Cutter Ø86-402mm	146/148	8	19
Feinbohrkopf / Fine boring head Ø86-402mm	256/258	8	19
Zweischneiderkopf / Twincutter boring head	142	9	22
Wendeplattenhalter / Insert holder	162/166/167/182	10	22
Brückenwerkzeuge / Bridge tool adapter	210/212	12	22
Verlängerungskonsolen / Extension bridge	221/223/224	12	22
Wendeplattenhalter / Insertholder	225/227/229	13	22
Feinbohrkopf / Fine boring head Ø150-2205mm	230/231/232	13	22
Feinbohrkopf / Fine Boring head	267 ECO HEAD	13	21
Bedienschlüssel / Service keys		14	
Modulare Schnittstelle / Modulare Interface	20/25/32/42/55/72/94	15	

Ersatzteile / Zubehör

Spare parts / Accessories

262/263

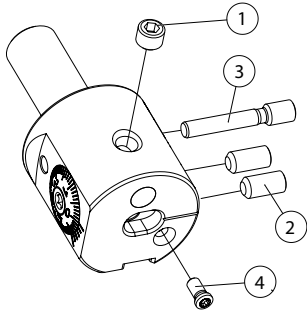

Type	max. Nm	S	Torque key	Bit	Service key
262/263.025.025					
① 881.262.250	1.4	2.5	893.000.012	893.001.025	892.000.025
② 882.262.250	2.4	2	893.000.022	893.001.020	892.000.020
③ A25-BG4.003.022					
④ 843.006.000					
262/263.032.032					
① 881.262.320	2.4	3	893.000.022	893.001.030	892.000.030
② 882.262.320	3.4	3	893.000.030	893.001.030	892.000.030
③ A32-BG4.003.028					
④ 843.006.000					

Ersatzteile / Zubehör

Spare parts / Accessories

262/266/269

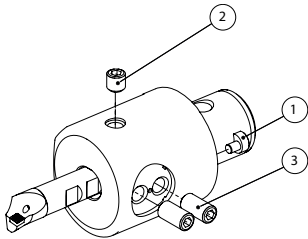

Type	max. Nm	S	Torque key	Bit	Service key
262/266/269					
② 881.262.551	8.0	5	893.000.057	893.001.050	892.000.050
③ 882.262.551	10.0	5			892.000.050

Ersatzteile / Zubehör

Spare parts / Accessories

267

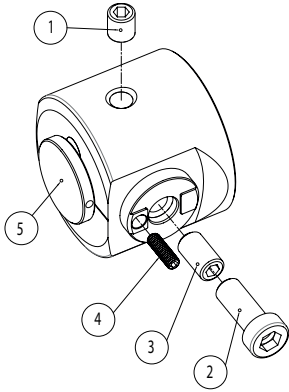

Type	max. Nm	S	Torque key	Bit	Service key
267.003.152					
① 881.267.012	8.0	5	893.000.057	893.001.050	892.000.050
② 880.267.025	10.0	8			892.000.080
③ 881.267.018	10.0	5			892.000.050
④ 881.267.014	3.0	2.5	893.000.030	893.001.025	892.000.025
⑤ 918.000.032					

Ersatzteile / Zubehör

Spare parts / Accessories

261

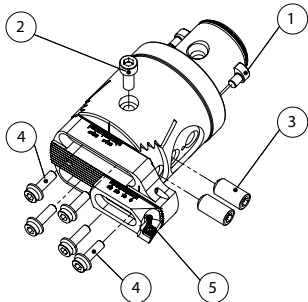

Type	max. Nm	S / Torx	Torque key	Bit	Service key	Service key
261.xxx.xxx.xxx						
② 881.261.016	8.0	5	893.000.057	893.001.050		892.000.050
③ 881.261.020	10.0	5				892.000.050
④ 883.261.016	5.0	4	893.000.050	893.001.040		892.000.040
⑤ 843.006.000 (256.xxx.006.xxx)	0.9	T7	893.000.009	893.002.007	842.006.000	
⑤ 843.009.000 (256.xxx.009.xxx)	3.0	T15	893.000.030	893.002.015	842.009.000	

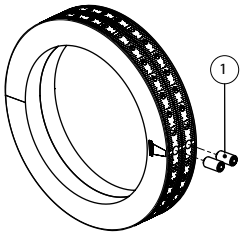

Ersatzteile / Zubehör

Spare parts / Accessories

264

Type	max. Nm	S	Torque key	Bit	Service key
264.xxxx.100					
① 887.550.000	1.4	2	893.000.012	893.001.020	892.000.020

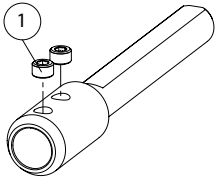

Ersatzteile / Zubehör

Spare parts / Accessories

268

Type	max. Nm	S	Torque key	Bit	Service key
268.016.010					
① 855.268.006	3.4	3	893.000.030	893.001.030	892.000.030
Type 268.016.016					
① 855.268.008	5.0	4	893.000.050	893.001.040	892.000.040

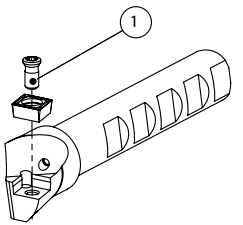

Ersatzteile / Zubehör

Spare parts / Accessories

272

Type	max. Nm	Torx	Torque key	Bit	Service key
272.010.006					
① 843.007.000	0.9	T7	893.000.009	893.002.007	842.006.000
Type 272.xxx.006					
① 843.006.000	0.9	T7	893.000.009	893.002.007	842.006.000
Type 272.xxx.009					
① 843.009.000	3.0	T15	893.000.030	893.002.015	842.009.000

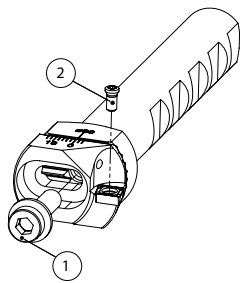

Ersatzteile / Zubehör

Spare parts / Accessories

253/271

Type	max. Nm	S / Torx	Torque key	Bit	Service key	Service key
271.xxx.xxx						
① 883.261.016	5.0	4	893.000.050	893.001.040	892.000.040	
Type 253.xxx.006						
② 843.006.000	0.9	T7	893.000.009	893.002.007		842.006.000
Type 253.xxx.009						
② 843.009.000	3.0	T15	893.000.030	893.002.015		842.009.000

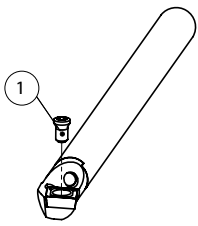

Ersatzteile / Zubehör

Spare parts / Accessories

274/278

Type	max. Nm	Torx	Torque key	Bit	Service key
274.xxx.002					
① 843.005.000	0.6	T6	893.000.006	893.002.006	842.005.000
Type 274.010.006					
① 843.007.000	0.9	T7	893.000.009	893.002.007	842.006.000
Type 274.xxx.006					
① 843.006.000	0.9	T7	893.000.009	893.002.007	842.006.000
Type 274.xxx.009					
① 843.009.000	3.0	15	893.000.030	893.002.015	842.009.000

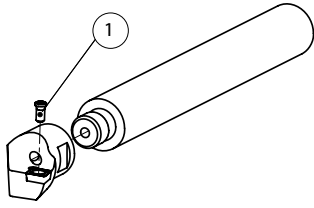

Ersatzteile / Zubehör

Spare parts / Accessories

278

Type	max. Nm	Torx	Torque key	Bit	Service key
Type 278.087-117.00x					
①	843.007.000	0.9	7	893.000.009	893.002.007 842.006.000
Type 278.127-347.006					
①	843.006.000	0.9	7	893.000.009	893.002.007 842.006.000

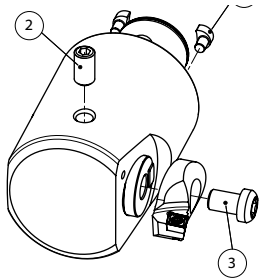

Ersatzteile / Zubehör

Spare parts / Accessories



280/281

Type	max. Nm	S / Torx	Torque key	Bit	Service key	Service key
Type 280.140.000						
②	881.280.140	0.9	1.5	893.000.009	893.001.015	892.000.015
③	882.280.140	0.9	T6	893.000.009	893.002.006	842.005.000
Type 280.160.000						
②	881.280.160	0.9	1.5	893.000.009	893.001.015	892.000.015
③	882.280.140	0.9	T6	893.000.009	893.002.006	842.005.000
Type 280.190.000						
②	881.280.180	0.9	1.5	893.000.009	893.001.015	892.000.015
③	882.280.140	0.9	T6	893.000.009	893.002.006	842.005.000
Type 280/281.020.041						
②	881.252.200	1.2	2	893.000.010	893.001.020	892.000.020
③	880.252.200	2.4	2.5	893.000.022	893.001.025	892.000.025
Type 280/281.025.045						
②	881.252.250	1.4	2.5	893.000.012	893.001.025	892.000.025
③	880.252.250	5.0	3	893.000.050	893.001.030	892.000.030
Type 280/281.032.051						
②	881.252.320	2.4	3	893.000.022	893.001.030	892.000.030
③	880.252.320	9.0	4			892.000.040

Ersatzteile / Zubehör

Spare parts / Accessories

251/252

Type 251/252.200.000	max. Nm	S	Torque key 	Bit 	Service key 
② 881.252.200	1.2	2	893.000.010	893.001.020	892.000.020
③ 880.252.200	2.4	2.5	893.000.022	893.001.025	892.000.025
Type 251/252.250.000					
② 881.252.250	1.4	2.5	893.000.012	893.001.025	892.000.025
③ 880.252.250	5.0	3	893.000.050	893.001.030	892.000.030
Type 251/252.320.000					
② 881.252.320	2.4	3	893.000.022	893.001.030	892.000.030
③ 880.252.320	9.0	4			892.000.040
Type 251/252.420.000					
② 881.252.420	4.0	4	893.000.038	893.001.040	892.000.040
③ 880.252.420	10.0	5			892.000.050
Type 251/252.550.000					
② 881.252.550	8.0	5	893.000.057	893.001.050	892.000.050
③ 880.252.550	20.0	8			892.000.080
Type 251/252.720.000					
② 881.252.720	8.0	5	893.000.057	893.001.050	892.000.050
③ 880.252.550	20.0	8			892.000.080
Type 251/252.940.000					
② 881.252.940	8.0	5	893.000.057	893.001.050	892.000.050
③ 880.252.550	20.0	8			892.000.080

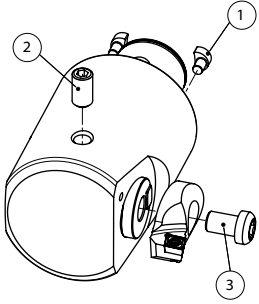

Ersatzteile / Zubehör

Spare parts / Accessories

266

Type 266.028.077	Size	Torx	Service key 
① 879.028.077		T6	842.005.000
② 879.011.045	AAA		

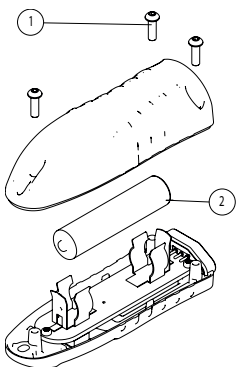

Ersatzteile / Zubehör

Spare parts / Accessories

254/282

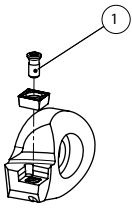



Type	max. Nm	Torx	Torque key	Bit	Service key
282.005.002	0.6	T6			
843.005.000			893.000.006	893.002.006	842.005.000
Type					
254.xxx.006	0.9	T7			
843.006.000			893.000.009	893.002.007	842.006.000
Type					
254.xxx.009	3.0	T15			
843.009.000			893.000.030	893.002.015	842.009.000

Ersatzteile / Zubehör

Spare parts / Accessories

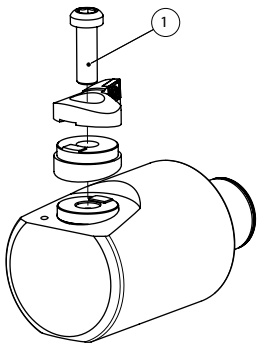
255



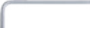



For reversal adapter Type	Order number	max. Nm	S	Torque key	Bit	Service key
255.200.001	880.252.201	2.4	2.5			
255.200.002	880.252.202	2.4	2.5	893.000.022	893.001.025	892.000.025
255.250.001	880.252.251	3.4	3	893.000.050	893.001.030	892.000.030
255.250.002	880.252.252	3.4	3	893.000.050	893.001.030	892.000.030
255.320.001	880.252.321	5.0	4			892.000.040
255.320.002	880.252.322	5.0	4			892.000.040
255.420.001	880.252.421	10.0	5			892.000.050
255.420.002	880.252.422	10.0	5			892.000.050
255.550.000	880.252.551	20.0	8			892.000.050

Ersatzteile / Zubehör

Spare parts / Accessories

146/148/256/258

Type 146/256.550.000	max. Nm	S / Torx	Torque key 	Bit 	Service key 	Service key 
②	850.256.550	8.0	6	893.000.057	893.001.060	893.000.060
③	850.144.550	25.0	6			893.000.060
Type 148/258.550.109						
④	190.550.109					
⑤	885.190.109					
⑥	884.190.109					
⑦	843.009.000	3.0	T15	893.000.030	893.002.015	842.009.000
Type 148/258.550.112						
④	190.550.112					
⑤	885.190.109					
⑥	884.190.109					
⑦	843.012.000	5.0	T20	893.000.050	893.002.020	842.012.000
Type 148/258.550.209						
④	190.550.209					
⑤	885.190.209					
⑥	884.190.209					
⑦	843.009.000	3.0	T15	893.000.030	893.002.015	842.009.000
Type 148/258.550.212						
④	190.550.212					
⑤	885.190.209					
⑥	884.190.209					
⑦	843.012.000	5.0	T20	893.000.050	893.002.020	842.012.000
Type 148/258.550.309						
④	190.550.309					
⑤	885.190.209					
⑥	884.190.209					
⑦	843.009.000	3.0	T15	893.000.030	893.002.015	842.009.000
Type 148/258.550.409						
④	190.550.409					
⑤	885.190.209					
⑥	884.190.209					
⑦	843.009.000	3.0	T15	893.000.030	893.002.015	842.009.000

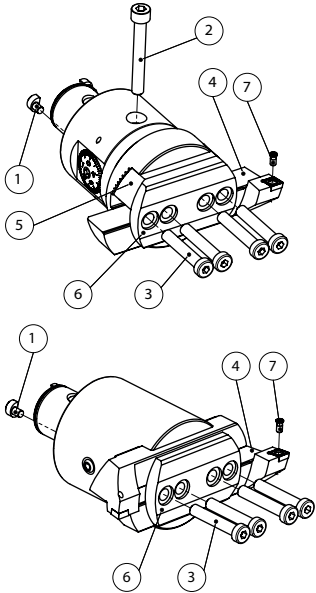

Type 142.200.000	max. Nm	S	Torque key 	Bit 	Service key 
② 840.142.200	2.4	2.5	893.000.022	893.001.025	893.000.025
③ 841.142.200					
④ 841.342.200					
Type 142.250.000					
② 840.142.250	5.0	3	893.000.050	893.001.030	893.000.030
③ 841.142.250					
④ 841.342.200					
Type 142.320.000					
② 840.142.320	9.0	4			893.000.040
③ 841.142.320					
④ 841.342.200					
Type 142.420.000					
② 840.142.420	20.0	5			893.000.050
③ 841.142.420					
④ 841.342.420					
Type 142.550.000					
② 840.142.550	35.0	6			893.000.060
③ 841.142.550					
④ 841.342.420					
Type 142.720.000					
② 840.142.720	35.0	8			893.000.080
③ 841.142.720					
④ 841.342.420					
Type 142.940.000					
② 840.142.940	35.0	10			893.000.100
③ 841.142.940					
④ 841.342.420					

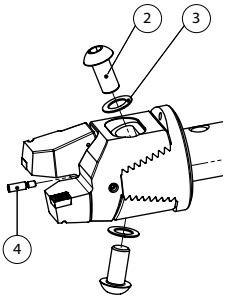

Ersatzteile / Zubehör

Spare parts / Accessories

162/167/182

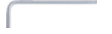

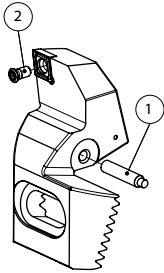

Type 162/167/182 200.006	max. Nm	S / Torx	Torque key 	Bit 	Service key 	Service key 
① 848.200.407		2			892.000.020	
② 843.006.000	0.9	T7	893.000.009	893.002.007		842.006.000
Type 162/167/182 250.006						
① 848.250.409		2			892.000.020	
② 843.006.000	0.9	T7	893.000.009	893.002.007		842.006.000
Type 162/167/182 320.009						
① 848.320.413		2			892.000.020	
② 843.009.000	3.0	T15	893.000.030	893.002.015		842.009.000
Type 162/167/182 420.009						
① 848.420.614		3			892.000.030	
② 843.009.000	3.0	T15	893.000.030	893.002.015		842.009.000
Type 162/167/182 550.xxx						
① 848.550.620		3			892.000.030	
② 843.012.000	5.0	T20	893.000.050	893.002.020		842.012.000
Type 162/167/182 720.xxx						
① 848.720.000		3			892.000.030	
② 843.012.000	5.0	T20	893.000.050	893.002.020		842.012.000
Type 162/167/182 940.xxx						
① 848.940.640		3			892.000.030	
② 843.012.000	5.0	T20	893.000.050	893.002.020		842.012.000



Ersatzteile / Zubehör



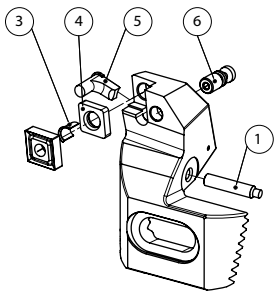

Spare parts / Accessories

162/182

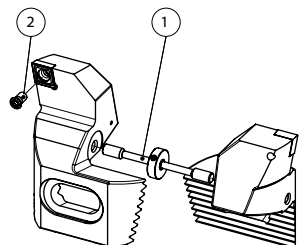
Type 162/182.550.xxx	max. Nm	S	Torque key 	Bit 	Service key 	Service key 
③ 844.012.000						
④ 845.012.000						
⑤ 846.012.000						
⑥ 847.012.000		3			892.000.030	
Type 162/182.720.xxx						
③ 844.016.000						
④ 845.016.000						
⑤ 846.016.000						
⑥ 847.016.000		3			892.000.030	
Type 162/182.840.xxx						
③ 844.016.000						
④ 845.016.000						
⑤ 846.016.000						
⑥ 847.016.000		4			892.000.040	





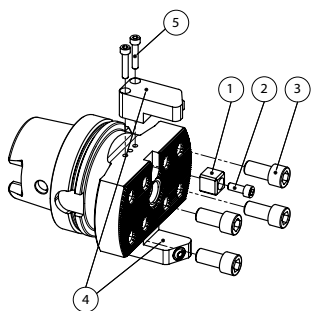

Type		max. Nm	S / Torx	Torque key 	Bit 	Service key 	Service key 
Type 166.200.006							
①	848.200.005		2			892.000.020	
②	843.006.000	0.9	T7	893.000.009	893.002.007		842.006.000
Type 166.250.006							
①	848.250.005		2			892.000.020	
②	843.006.000	0.9	T7	893.000.009	893.002.007		842.006.000
Type 166.320.009							
①	848.320.005		2			892.000.020	
②	843.009.000	3.0	T15	893.000.030	893.002.015		842.009.000
Type 166.420.009							
①	848.420.005		3			892.000.030	
②	843.009.000	3.0	T15	893.000.030	893.002.015		842.009.000
Type 166.550.012							
①	848.550.005		3			892.000.030	
②	843.012.000	5.0	T20	893.000.050	893.002.020		842.012.000
Type 166.720.012							
①	848.720.005		3			892.000.030	
②	843.012.000	5.0	T20	893.000.050	893.002.020		842.012.000
Type 166.940.012							
①	848.940.005		3			892.000.030	
②	843.012.000	5.0	T20	893.000.050	893.002.020		842.012.000



Ersatzteile / Zubehör

Spare parts / Accessories

210/212

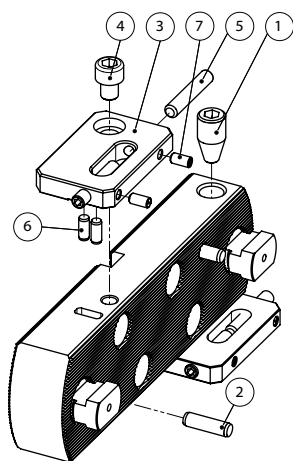

Type 210/212	max. Nm	S	Torque key 	Bit 	Service key 
① 810.212.362					
② 811.210.212	8	5			892.000.050
③ 812.210.212	60	10			892.000.100
④ 920.028.015					
⑤ 920.029.025	5	4			892.000.040



Ersatzteile / Zubehör

Spare parts / Accessories

221/224

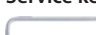

Type 221/224	max. Nm	S / Torx	Torque key 	Bit 	Service key 
① 860.220.000	50.0	8			892.000.080
② 864.220.000					
⑦ 877.221.112					
Type 221.130/230.000					
③ 877.221.000					
④ 877.221.012	35.0	8			892.000.080
⑤ 877.221.045		4			892.000.040
⑥ 877.221.014					
Type 221.180/280-580.000 224.xxx.048					
③ 877.221.000					
④ 877.221.018	35.0	8			892.000.080
⑤ 877.221.045		4			892.000.040
⑥ 877.221.014					

Ersatzteile / Zubehör

Spare parts / Accessories

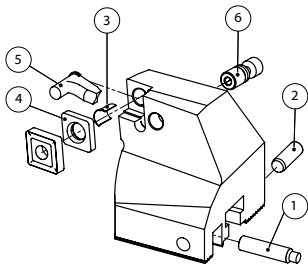
225/227/229







Type 225/227/229	max. Nm	S / Torx	Torque key 	Bit 	Service key 
①	865.224.230	4			892.000.040
②	865.225.024				
Type 225/227.000.012					
③	844.012.000				
④	845.012.000				
⑤	846.012.000				
⑥	847.012.000	3			892.000.030
Type 225/227/229.000.019					
③	844.019.000				
④	845.019.000				
⑤	846.019.000				
⑥	847.019.000	3			892.000.030

Ersatzteile / Zubehör

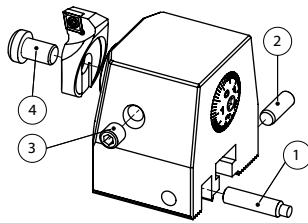
Spare parts / Accessories

230/231/232







Type 230/230.000.000	max. Nm	S / Torx	Torque key 	Bit 	Service key 
①	865.224.230	4			892.000.040
②	865.225.024				
③	881.230.000	8	5	893.000.057	893.001.050
④	880.252.550	35.0	8		892.000.080
Type 232.000.000					
①	865.224.230	4			892.000.040
②	865.225.024				

Ersatzteile / Zubehör

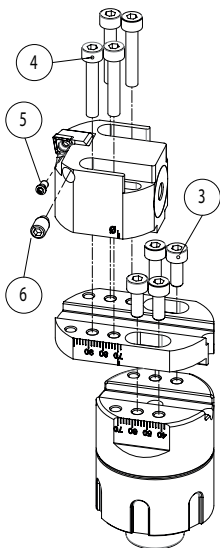
Spare parts / Accessories

267



Type 267.040.070	max. Nm	S / Torx	Torque key 	Bit 	Service key 	Service key 
③	858.216.010	4.5	3	893.000.042	893.001.030	892.000.030
④	858.216.025	4.5	3	893.000.042	893.001.030	892.000.030
⑤	843.006.000	0.9	T7	893.000.009	893.002.007	842.006.000
⑥	881.216.008	1.2	2.5	893.000.010	893.001.025	892.000.025



Torque key	Nm
893.000.006	0.6
893.000.009	0.9
893.000.010	1.0
893.000.012	1.2
893.000.018	1.8
893.000.022	2.2
893.000.030	3.0
893.000.038	3.8
893.000.042	4.2
893.000.050	5.0
893.000.057	5.7



Service key set	S
892.000.158	1.5 - 8
892.000.151	1.5-10



Service key	S
892.000.015	1.5
892.000.020	2
892.000.025	2.5
892.000.030	3
892.000.040	4
892.000.050	5
892.000.060	6
892.000.080	8
892.000.100	10
892.000.120	12
892.000.140	14



Torx bit	Tx
893.002.005	5
893.002.006	6
893.002.007	7
893.002.008	8
893.002.009	9
893.002.010	10
893.002.015	15
893.002.020	20



Hexagon bit	S
893.001.015	1.5
893.001.020	2
893.001.025	2.5
893.001.030	3
893.001.040	4
893.001.050	5
893.001.060	6
893.001.080	8



Torx key	Tx
842.005.000	6
842.006.000	7
842.009.000	15
842.012.000	20

Ersatzteile / Zubehör

Spare parts / Accessories

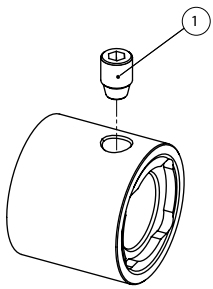

Für System ø D For system ø D	Bestell-Nr. / Order number	Klemmschraube / Clamping screw ①	Gewinde / Thread	S
20	800.000.200	M5x0.5	2.5	
25	800.000.250	M6x0.75	3	
32	800.000.320	M8x1	4	
42	800.000.420	M12x1	6	
55	800.000.550	M12x1	6	
72	800.000.720	M16x1.5	8	
94	800.000.940	M20x1.5	10	

INSTRUCTION MANUAL
Ø 0.3 - 19.1 mm



assembling boring bar

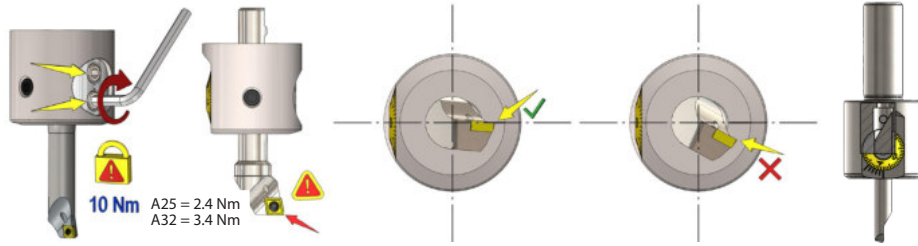

diameter adjustment

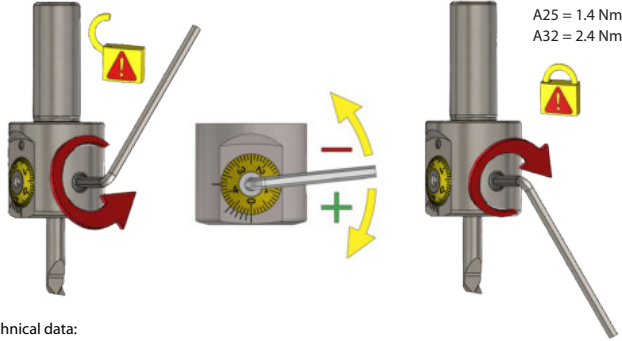

scale / vernier

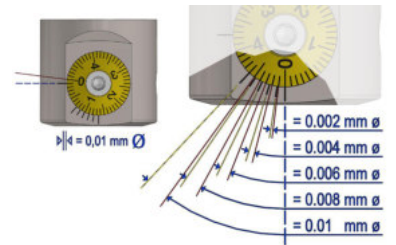

Technical data:

Boring range: A25 Ø 0.3 - 7.1 mm
 A32 Ø 0.3 - 19.1 mm

Tool holder bore: A25 Ø 4.0 mm
 A32 Ø 7.0 mm

Max. Spindle speed: 30.000 rpm

Adjustment range: A25 -0.1 / + 3.0 mm Ø
 A32 -0.1 / + 5.0 mm Ø

INSTRUCTION MANUAL
Ø 3.0 - 88.1 mm



assembling boring bar

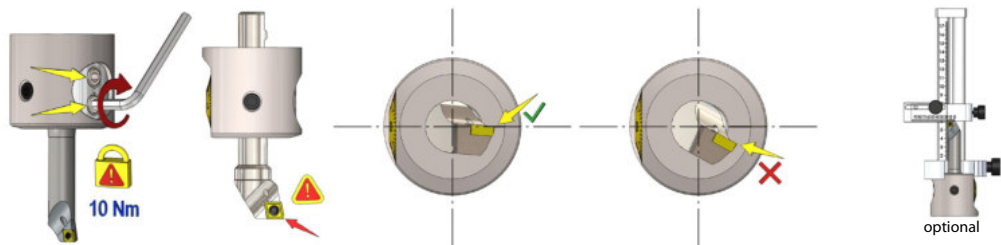

diameter adjustment

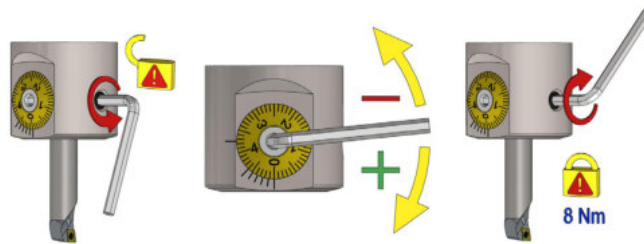

scale / vernier

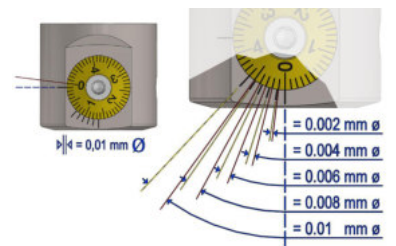

Max. revolution

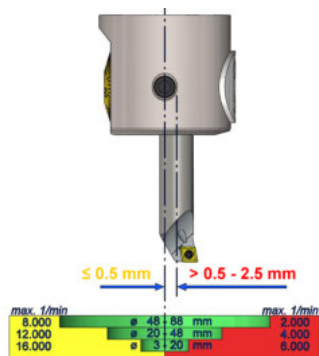

INSTRUCTION MANUAL
Multi-Head Ø 3-320 mm



assembling boring bar

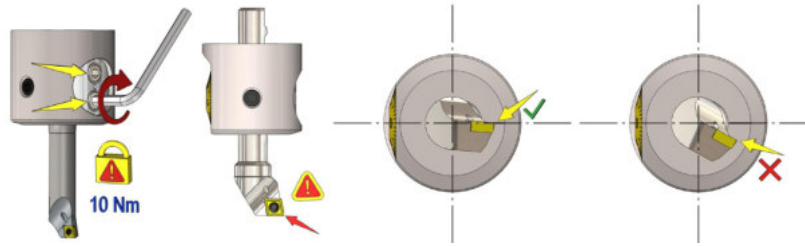

diameter adjustment

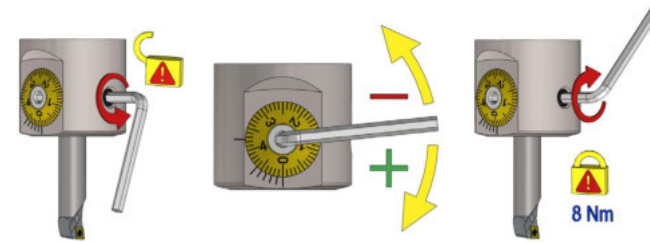

scale / vernier

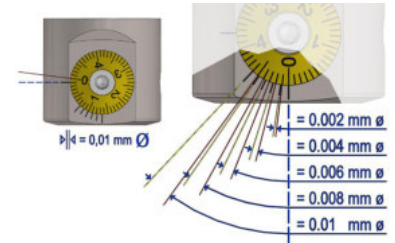

optional

Max. revolution

max. 1/min	≤ 0.5 mm	> 0.5 - 2.5 mm	max. 1/min
8.000	ø 48 - 98 mm		2.000
12.000	ø 20 - 48 mm		4.000
16.000	ø 3 - 20 mm		6.000

Vmax 450 m/min (Ø88.0 - 164.0)
Vmax 250 m/min (Ø164.0 - 320.0)

assembling Ø86-320mm

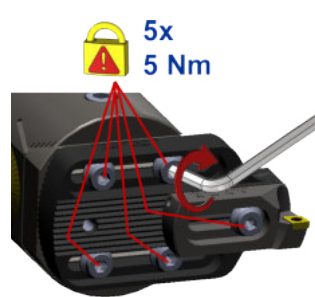

presetting scale

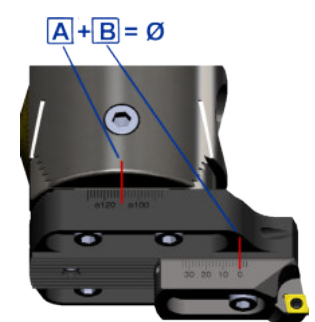

INSTRUCTION MANUAL
VARIO HEAD Ø 3 - 152 mm



assembling boring bar

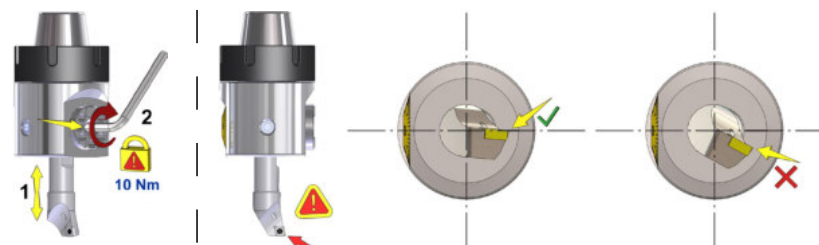

assembling coolant plug

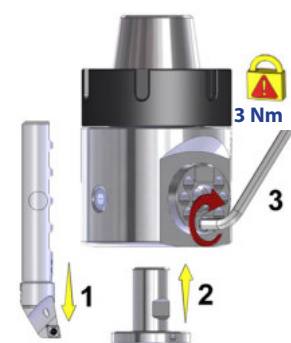

assembling insertholder

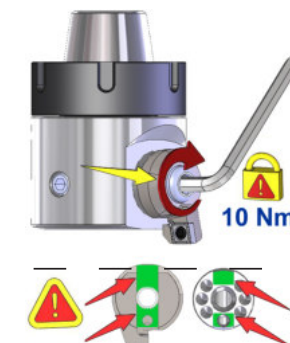

scale / vernier

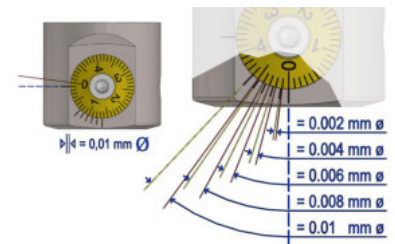

optional

diameter adjustment

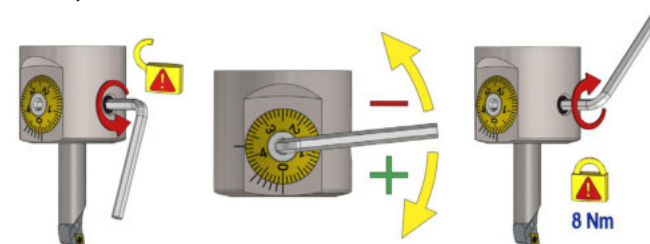

back boring

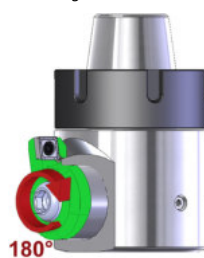

FINE BORING HEAD
Ø 24 - 171 mm

assembling boring head

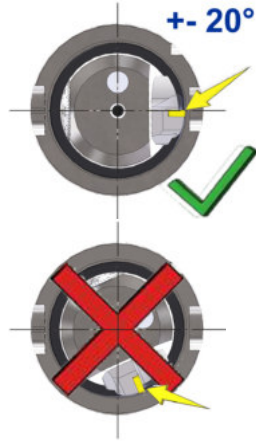

assembling insertholder

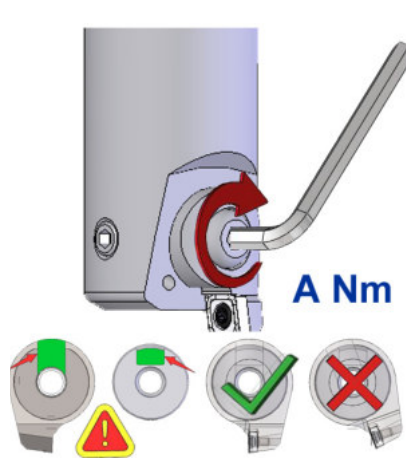

back boring (requires a reversal adapter)



diameter adjustment

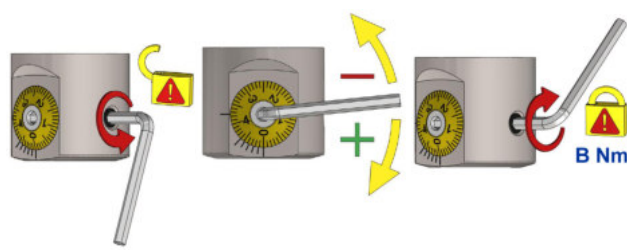

scale / vernier

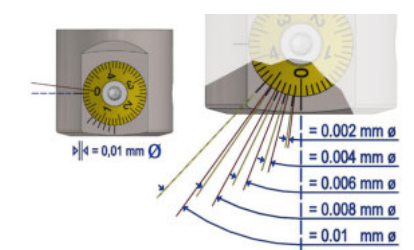

Fine boring head	Nm A	Nm B	max. rpm balanced	max. rpm unbalanced
D20 / Ø 24-31	2.4	1.2	12.000	9.000
D25 / Ø 31-40	3.4	1.4	10.000	7.500
D32 / Ø 40-51	5.0	2.4	8.000	5.250
D42 / Ø 51-67	10	4.0	6.500	4.000
D55 / Ø 67-87	20	8	5.000	3.000
D72 / Ø 87-116	20	8	4.000	2.500
D94 / Ø 116 - 171	20	8	3.000	1.750

INSTRUCTION MANUAL
Fine + Rough boring head
Ø 86 - 402 mm

assembling

Ø86 - 138
2x 25Nm
 < Ø136
4x 25Nm

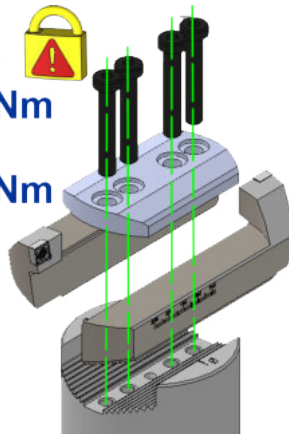

pre adjustment / coolant

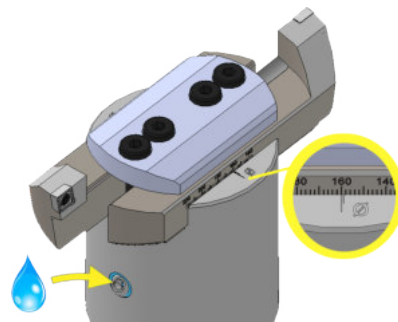

adjustment fine boring

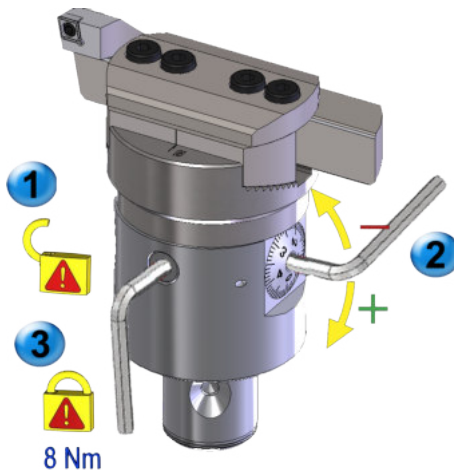

scale / vernier

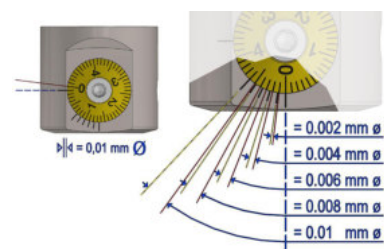

Digital display unit

Function / maintenance

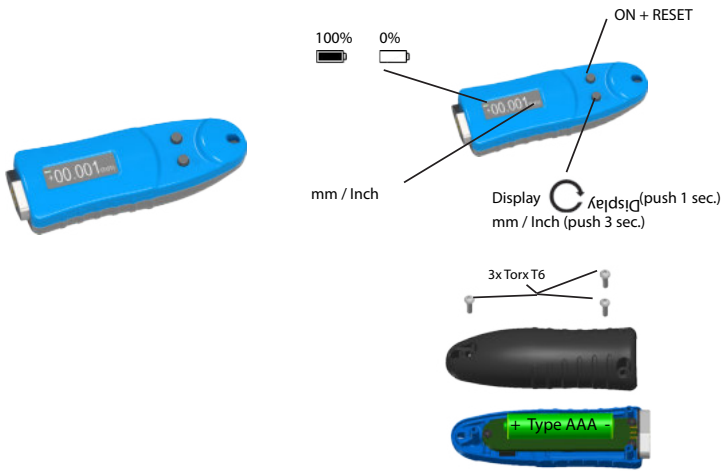

Handling

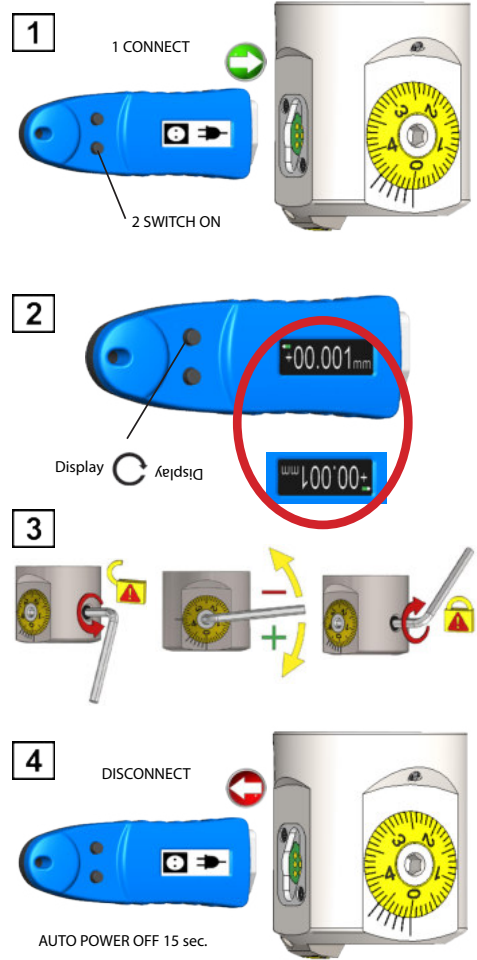

assembling boring bar



ø A min.	ø A max.	D	L	L1	Wendeplatte / Insert	M	SW	Nm
8.75	14.1	8	56	91	CC...06 02..	5	7	6
9.75	15.1	9	63	98	CC...06 02..	5	8	6
10.75	16.1	10	70	105	CC...06 02..	6	8	9
11.75	17.1	11	77	112	CC...06 02..	6	9	9
12.75	18.1	12	84	119	CC...06 02..	6	10	9
13.75	19.1	13	91	126	CC...06 02..	6	11	9
14.75	20.1	14	98	133	CC...06 02..	6	12	9
15.75	21.1	14	98	133	CC...06 02..	6	12	9
16.75	22.1	16	112	147	CC...06 02..	10	14	20
17.75	23.1	16	112	147	CC...06 02..	10	14	20
19.75	25.1	16	112	147	CC...06 02..	10	14	20
21.75	27.1	16	112	147	CC...06 02..	10	14	20
24.75	30.1	16	112	147	CC...06 02..	10	14	20
27.75	33.1	16	112	147	CC...06 02..	10	14	20
31.75	37.1	16	112	147	CC...06 02..	10	14	20
34.75	40.1	16	112	147	CC...06 02..	10	14	20

ROUGH BORING HEAD
Ø 23 - 153 mm

assembling insertholder
synchronous adjustment

single adjustment

torque / revolution

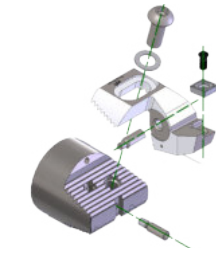
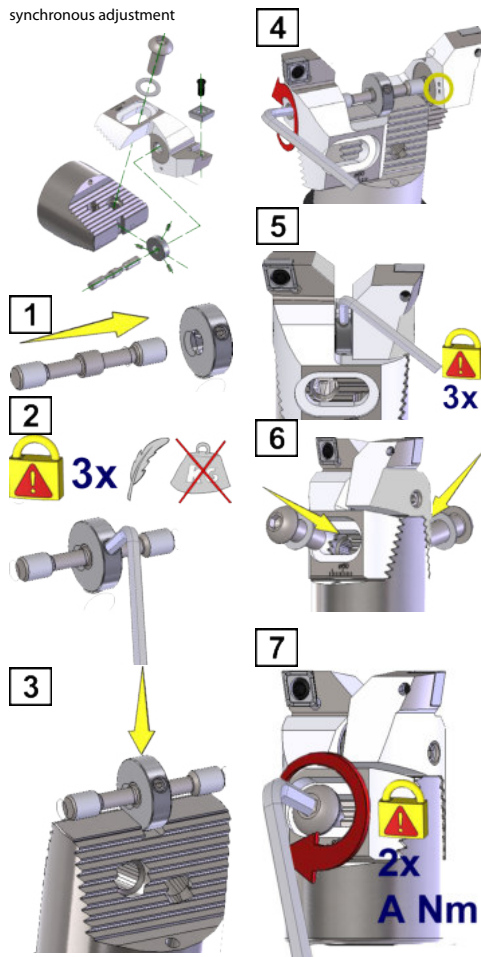

Rough boring head	Nm A	max. rpm
D20 / Ø 23-31	2.4	12.000
D25 / Ø 31-40	5	10.000
D32 / Ø 40-51	9	8.000
D42 / Ø 51-67	20	6.500
D55 / Ø 67-87	35	5.000
D72 / Ø 87-116	35	4.000
D94 / Ø 116 - 153	35	3.000

+ [6] + [7]

diameter adjustment

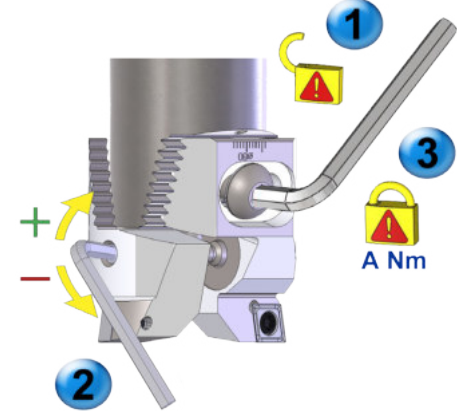

INSTRUCTION MANUAL
BRIDGE TOOLS Ø 150 - 655 mm

assembling

revolution

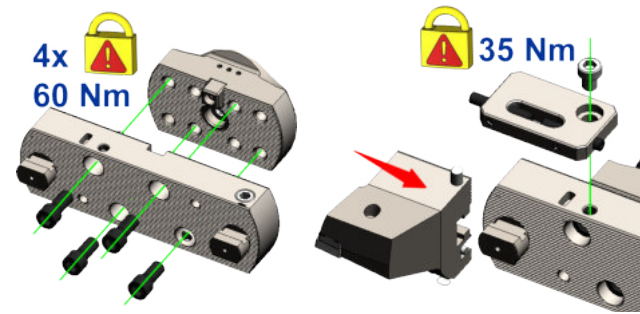

diameter	max. rpm
Ø150-205	1.250
Ø200-255	1.000
Ø250-305	850
Ø300-355	700
Ø350-405	600
Ø400-455	530
Ø450-505	480
Ø500-555	440
Ø550-605	400
Ø600-655	360

pre adjustment

scale / vernier

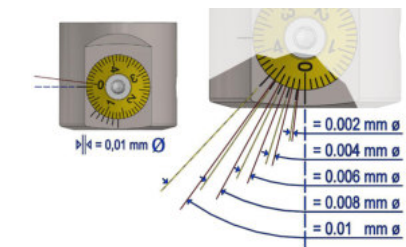
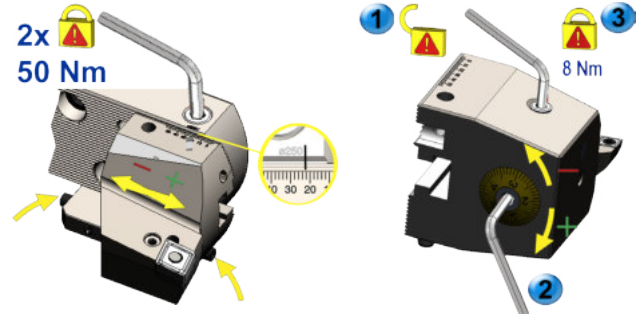

pin turning

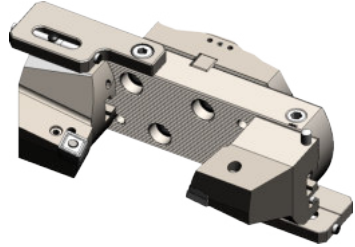

INSTRUCTION MANUAL
ECO HEAD Ø 39.9 - 100.1 mm

assembling rough adjustment Ø 39.9 - 70.1mm

assembling rough adjustment Ø 69.9 - 100.1mm

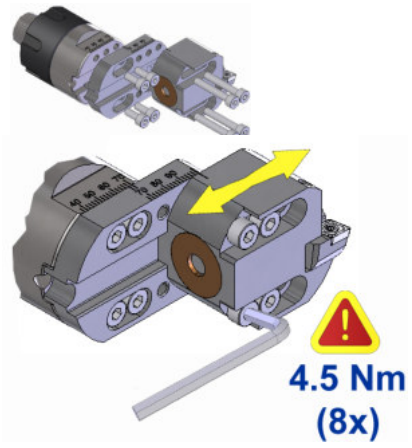
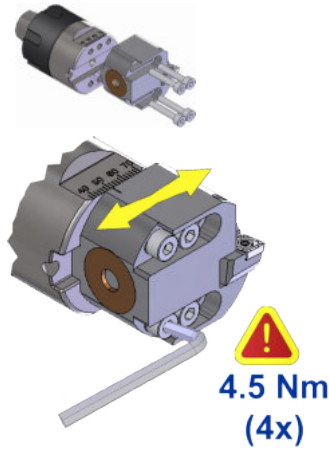
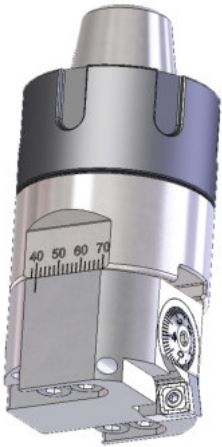

diameter fine adjustment

scale / vernier

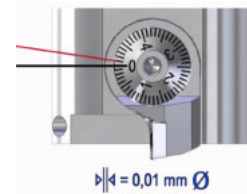
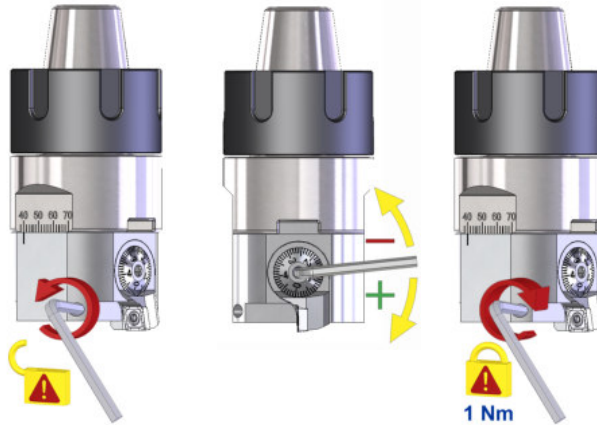

maximum spindle speed

$V_{max} = 450 \text{ m/min } (\varnothing 40-70)$
 $V_{max} = 250 \text{ m/min } (\varnothing 70-100)$

Balancing ring

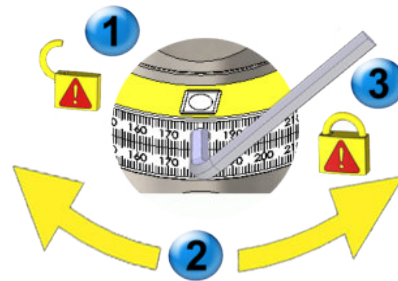
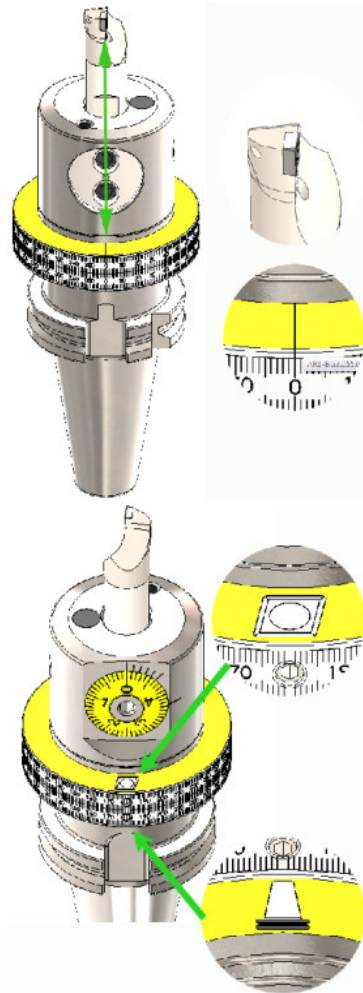
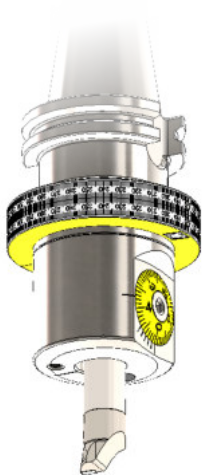

Auswuchtabelle / balancing chart

Ausdrehkopf / fine boring head		Einstellwert am Auswuchtring / presetting value on the balancing ring											
Bestellnummer / order number													
Ausdrehstahl / boring bar													
Bestellnummer / order number	\varnothing	\varnothing	\varnothing	\varnothing	\varnothing	\varnothing	\varnothing	\varnothing	\varnothing	\varnothing	\varnothing	\varnothing	\varnothing
272.010.006	10	103	284	11	91	290	12	84	291	13			
272.012.006	12	104	295	13	91	291	14	84	292	15			
272.014.006	14	104	295	15	91	291	16	83	292	17			
272.015.006	15	105	297	16	92	292	17	83	293	18			
272.016.006	16	107	299	17	92	293	18	83	294	19			
272.018.006	18	108	301	19	93	294	20	83	295	21			





SWISSE TOOLS[®] Swiss Tool Systems AG
Wydenstrasse 28
CH-8575 Bürglen
Phone +41 (0)71 634 85 20
Fax +41 (0)71 634 85 29
www.swisstools.org