

1704

**Ersatzteile
Zubehör**

**Spare parts
Accessories**

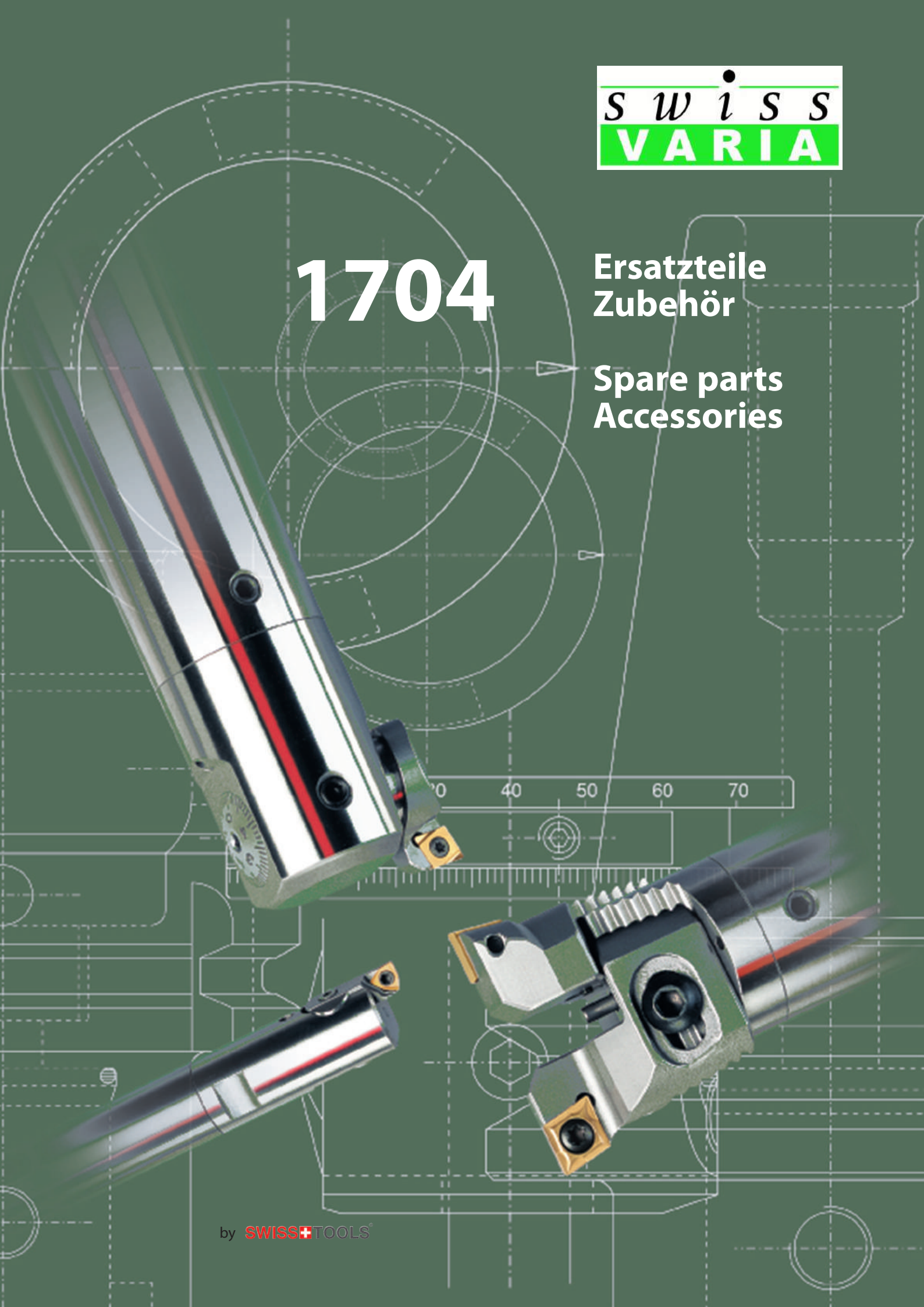

Inhaltsverzeichnis / Table of contents

	Typ / Type	Ersatzteilliste / Spare part list Seite / Page	Bedienungsanleitung / Instruction manual Seite / Page
Ausdrehkopf / Fine boring head	B04/B06 MICRO HEAD	3	15
	B04/B06/B08/B09/B11	3	15
	B05 VARIO HEAD	3	16
	B10 MULTI HAED	3	16
Auswuchtring / Balancing ring	B16	4	21
Ausdrehstahlverlängerung / Boring bar extension	B34	4	
Ausdrehstahl / Boring Bar	B54	4	
	B56	4	
	B74	4	
	B94	5	18
Feinbohrkopf / Fine boring head	C00/C01	5	18
	C04/C05	6	18
Anzeigeeinheit / Display unit	C09	6	19
Wendeplattenhalter / Insert holder	C02/C14/C15	7	
Umkehradapter / Reversal adapter	C24	7	
Zweischneiderkopf / Twin Cutter Ø86-402mm	C44/C54	8	19
Feinbohrkopf / Fine boring head Ø86-402mm	D44/D54	8	19
Zweischneiderkopf / Twincutter boring head	D04	9	22
Wendeplattenhalter / Insert holder	D14/D24/D37	10	22
	D34	11	22
Brückenwerkzeuge / Bridge tool adapter	E04/E14/E34/E44/E54	12	22
Verlängerungskonsolen / Extension bridge	E60/E62/E64	12	22
Wendeplattenhalter / Insertholder	E70/E80	13	22
Feinbohrkopf / Fine boring head Ø150-2205mm	E90/E91/E94	13	22
Feinbohrkopf / Fine Boring head	E98 ECO HEAD	13	21
Bedienschlüssel / Service keys		14	
Modulare Schnittstelle / Modulare Interface	WH1 - WH8	15	

Ersatzteile / Zubehör

Spare parts / Accessories

B04/B06

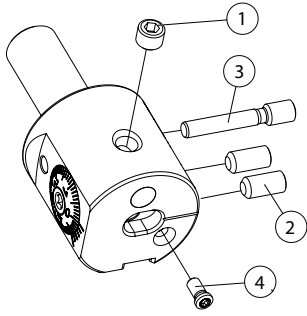

Type	max. Nm	S	Torque key	Bit	Service key
Type B04/B06.010.025.025					
① J00.204.005.004	1.4	2.5	J00.895.000.012	J00.895.001.025	J00.892.000.025
② J00.204.004.008	2.4	2	J00.895.000.022	J00.895.001.020	J00.892.000.020
③ A25-BG4.003.022					
④ J00.254.025.006					
Type 204/206.016.032.032					
① J00.204.006.005	2.4	3	J00.895.000.022	J00.895.001.030	J00.892.000.030
② J00.204.006.010	3.4	3	J00.895.000.030	J00.895.001.030	J00.892.000.030
③ A32-BG4.003.028					
④ J00.254.025.006					

Ersatzteile / Zubehör

Spare parts / Accessories

B04/B06/B08/B09/B11

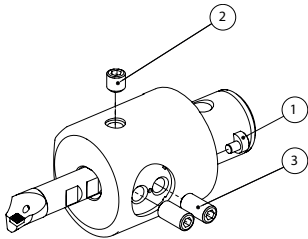

Type	max. Nm	S	Torque key	Bit	Service key
Type B04 / B06 / B08 / B09 / B11					
② J00.204.010.008	8.0	5	J00.895.000.057	J00.895.001.050	J00.892.000.050
③ J00.204.010.016	10.0	5			J00.892.000.050

Ersatzteile / Zubehör

Spare parts / Accessories

B05

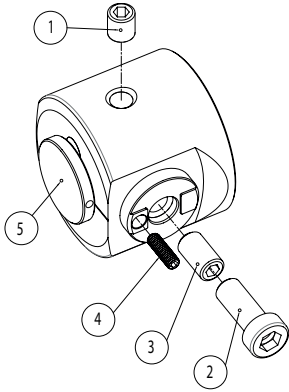

Type	max. Nm	S	Torque key	Bit	Service key
Type B05.063.025.050					
① J00.205.010.012	8.0	5	J00.895.000.057	J00.895.001.050	J00.892.000.050
② J00.205.010.025	10.0	8			J00.892.000.080
③ J00.205.010.018	10.0	5			J00.892.000.050
④ J00.205.003.014	3.0	2.5	J00.895.000.030	J00.895.001.025	J00.892.000.025
⑤ J00.805.000.032					

Ersatzteile / Zubehör

Spare parts / Accessories

B10

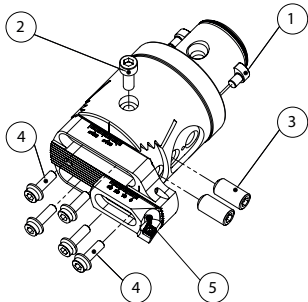

Type	max. Nm	S / Torx	Torque key	Bit	Service key	Service key
Type B10.xxx.xxx.xxx						
② J00.210.006.016	8.0	5	J00.895.000.057	J00.895.001.050		J00.892.000.050
③ J00.210.010.020	10.0	5				J00.892.000.050
④ J00.256.005.016	5.0	4	J00.895.000.050	J00.895.001.040		J00.892.000.040
⑤ J00.254.025.006 (256.xxx.006.xxx)	0.9	T7	J00.895.000.009	J00.895.002.007	J00.254.007.000	
⑤ J00.254.040.009 (256.xxx.009.xxx)	3.0	T15	J00.895.000.030	J00.895.002.015	J00.254.009.000	

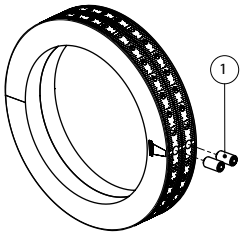

Ersatzteile / Zubehör

Spare parts / Accessories

B16

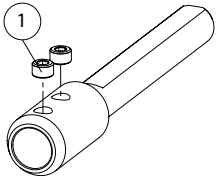

Type B16.xxxx.xxx.016	max. Nm	S	Torque key 	Bit 	Service key 
① J00.216.004.008	1.4	2	J00.895.000.012	J00.895.001.020	J00.892.000.020



Ersatzteile / Zubehör

Spare parts / Accessories

B34

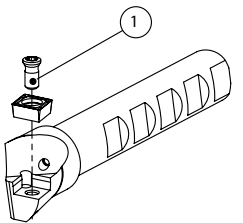

Type B34.016.010.128	max. Nm	S	Torque key 	Bit 	Service key 
① J00.234.006.003	3.4	3	J00.895.000.030	J00.895.001.030	J00.892.000.030
Type B34.016.016.148					
① J00.234.008.005	5.0	4	J00.895.000.050	J00.895.001.040	J00.892.000.040



Ersatzteile / Zubehör

Spare parts / Accessories

B54

Type B54.010.006.075	max. Nm	Torx	Torque key 	Bit 	Service key 
① J00.254.025.005	0.9	T7	J00.895.000.009	J00.895.002.007	J00.254.007.000
Type B54.xxx.006.xxx					
① J00.254.025.006	0.9	T7	J00.895.000.009	J00.895.002.007	J00.254.007.000
Type B54.xxx.009.xxx					
① J00.254.040.009	3.0	T15	J00.895.000.030	J00.895.002.015	J00.254.009.000

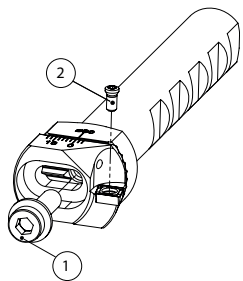

Ersatzteile / Zubehör

Spare parts / Accessories

B56

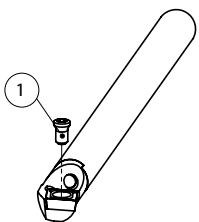

Type B56.xxx.xxx.115	max. Nm	S / Torx	Torque key 	Bit 	Service key 	Service key 
① J00.256.005.016	5.0	4	J00.895.000.050	J00.895.001.040	J00.892.000.040	
Type B56.xxx.006.xxx						
② J00.254.025.006	0.9	T7	J00.895.000.009	J00.895.002.007		J00.254.007.000
Type B56.xxx.009.xxx						
② J00.254.040.009	3.0	T15	J00.895.000.030	J00.895.002.015		J00.254.009.000



Ersatzteile / Zubehör

Spare parts / Accessories

B74

Type B74.xxx.002.xxx	max. Nm	Torx	Torque key 	Bit 	Service key 
① J00.254.020.004	0.6	T6	J00.895.000.006	J00.895.002.006	J00.254.006.000
Type B74.010.006.120					
① J00.254.025.005	0.9	T7	J00.895.000.009	J00.895.002.007	J00.254.007.000
Type B74.xxx.006.xxx					
① J00.254.025.006	0.9	T7	J00.895.000.009	J00.895.002.007	J00.254.007.000
Type B74.xxx.009.xxx					
① J00.254.040.009	3.0	15	J00.895.000.030	J00.895.002.015	J00.254.009.000

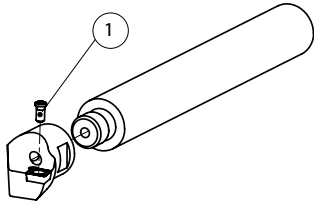

Ersatzteile / Zubehör

Spare parts / Accessories

B94

Type	max. Nm	Torx	Torque key	Bit	Service key
Type B94.009-012.006.0xx					
① J00.254.025.005	0.9	7	J00.895.000.009	J00.895.002.007	J00.254.007.000
Type B94.013-035.006.xxx					
① J00.254.025.006	0.9	7	J00.895.000.009	J00.895.002.007	J00.254.007.000

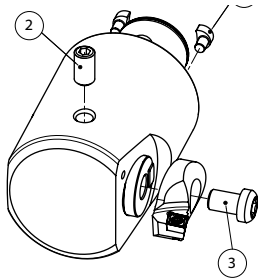

Ersatzteile / Zubehör

Spare parts / Accessories

C00/C01

Type	max. Nm	S / Torx	Torque key	Bit	Service key	Service key
Type C00.014.015.040						
② J00.881.280.140	0.9	1.5	J00.895.000.009	J00.895.001.015	J00.892.000.015	
③ J00.882.280.140	0.9	T6	J00.895.000.009	J00.895.002.006		J00.254.006.000
Type C00.016.017.040						
② J00.881.280.160	0.9	1.5	J00.895.000.009	J00.895.001.015	J00.892.000.015	
③ J00.882.280.160	0.9	T6	J00.895.000.009	J00.895.002.006		J00.254.006.000
Type C00.019.020.040						
② J00.881.280.180	0.9	1.5	J00.895.000.009	J00.895.001.015	J00.892.000.015	
③ J00.882.280.180	0.9	T6	J00.895.000.009	J00.895.002.006		J00.254.006.000
Type C00/C01.020.024.041						
② J00.304.004.003	1.2	2	J00.895.000.010	J00.895.001.020	J00.892.000.020	
③ J00.314.004.006	2.4	2.5	J00.895.000.022	J00.895.001.025	J00.892.000.025	
Type C00/C01.025.031.045						
② J00.304.005.004	1.4	2.5	J00.895.000.012	J00.895.001.025	J00.892.000.025	
③ J00.314.005.008	5.0	3	J00.895.000.050	J00.895.001.030	J00.892.000.030	
Type C00/C01.032.040.051						
② J00.304.006.005	2.4	3	J00.895.000.022	J00.895.001.030	J00.892.000.030	
③ J00.314.006.010	9.0	4			J00.892.000.040	

Ersatzteile / Zubehör

Spare parts / Accessories

C04/C05

Type C04/C05.020.024.045	max. Nm	S	Torque key 	Bit 	Service key 
-----------------------------	------------	---	---	--	--

②	J00.304.004.003	1.2	2	J00.895.000.010	J00.895.001.020	J00.892.000.020
---	-----------------	-----	---	-----------------	-----------------	-----------------

③	J00.314.004.006	2.4	2.5	J00.895.000.022	J00.895.001.025	J00.892.000.025
---	-----------------	-----	-----	-----------------	-----------------	-----------------

Type
C04/C05.025.031.056

②	J00.304.005.004	1.4	2.5	J00.895.000.012	J00.895.001.025	J00.892.000.025
---	-----------------	-----	-----	-----------------	-----------------	-----------------

③	J00.314.005.008	5.0	3	J00.895.000.050	J00.895.001.030	J00.892.000.030
---	-----------------	-----	---	-----------------	-----------------	-----------------

Type
C04/C05.032.040.066

②	J00.304.006.005	2.4	3	J00.895.000.022	J00.895.001.030	J00.892.000.030
---	-----------------	-----	---	-----------------	-----------------	-----------------

③	J00.314.006.010	9.0	4			J00.892.000.040
---	-----------------	-----	---	--	--	-----------------

Type
C04/C05 .039.051.075

②	J00.304.008.006	4.0	4	J00.895.000.038	J00.895.001.040	J00.892.000.040
---	-----------------	-----	---	-----------------	-----------------	-----------------

③	J00.314.008.012	10.0	5			J00.892.000.050
---	-----------------	------	---	--	--	-----------------

Type
C04/C05.050.067.090

②	J00.304.010.010	8.0	5	J00.895.000.057	J00.895.001.050	J00.892.000.050
---	-----------------	-----	---	-----------------	-----------------	-----------------

③	J00.314.010.016	20.0	8			J00.892.000.080
---	-----------------	------	---	--	--	-----------------

Type
C04/C05.063.087.110

②	J00.304.010.018	8.0	5	J00.895.000.057	J00.895.001.050	J00.892.000.050
---	-----------------	-----	---	-----------------	-----------------	-----------------

③	J00.314.010.016	20.0	8			J00.892.000.080
---	-----------------	------	---	--	--	-----------------

Type
C04/C05.080.115.140

②	J00.304.010.030	8.0	5	J00.895.000.057	J00.895.001.050	J00.892.000.050
---	-----------------	-----	---	-----------------	-----------------	-----------------

③	J00.314.010.016	20.0	8			J00.892.000.080
---	-----------------	------	---	--	--	-----------------

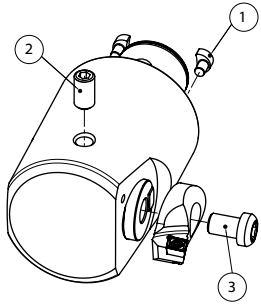

Ersatzteile / Zubehör

Spare parts / Accessories

C09

Type C09.028.024.077	Size	Torx	Service key 
-------------------------	------	------	--

①	J00.309.022.008	T6	J00.254.006.000
---	-----------------	----	-----------------

②	J00.308.011.045	AAA	
---	-----------------	-----	--

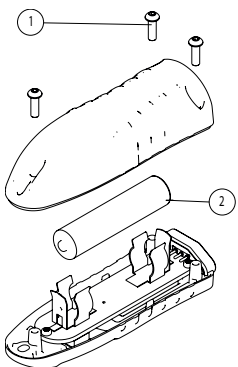

Ersatzteile / Zubehör

Spare parts / Accessories

C02/C14/C15

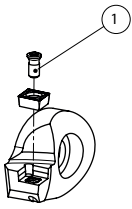





Type C02.005.017.002	max. Nm	Torx	Torque key 	Bit 	Service key 
J00.254.020.004	0.6	T6	J00.895.000.006	J00.895.002.006	J00.254.006.000
Type C14/C15.xxx.xxx.006					
J00.254.025.006	0.9	T7	J00.895.000.009	J00.895.002.007	J00.254.007.000
Type C14/C15.xxx.xxx.009					
J00.254.040.009	3.0	T15	J00.895.000.030	J00.895.002.015	J00.254.009.000

Ersatzteile / Zubehör

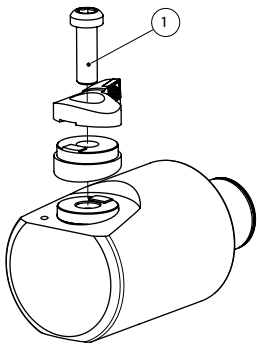
Spare parts / Accessories

C24







For reversal adapter Type	Order number 	max. Nm	S	Torque key 	Bit 	Service key 
C24.011.065.008	J00.324.004.012	2.4	2.5	J00.895.000.022	J00.895.001.025	J00.892.000.025
C24.011.080.008	J00.324.004.013	2.4	2.5	J00.895.000.022	J00.895.001.025	J00.892.000.025
C24.013.065.007	J00.324.005.014	3.4	3	J00.895.000.050	J00.895.001.030	J00.892.000.030
C24.013.100.007	J00.324.005.016	3.4	3	J00.895.000.050	J00.895.001.030	J00.892.000.030
C24.017.065.013	J00.324.006.015	5.0	4			J00.892.000.040
C24.017.100.013	J00.324.006.020	5.0	4			J00.892.000.040
C24.022.065.016	J00.324.008.020	10.0	5			J00.892.000.050
C24.022.120.016	J00.324.008.025	10.0	5			J00.892.000.050
C24.030.100.027	J00.324.010.030	20.0	8			J00.892.000.050

Ersatzteile / Zubehör

Spare parts / Accessories

C44/C54/D44/D54

Type C44/D44.064.086.112	max. Nm	S / Torx	Torque key 	Bit 	Service key 	Service key 
② J00.344.008.065	8.0	6	J00.895.000.057	J00.895.001.060	J00.892.000.060	
③ J00.344.008.044	25.0	6			J00.892.000.060	
Type C54/D54.086.138.009						
④ J00.354.086.009						
⑤ J00.345.020.086						
⑥ J00.345.010.086						
⑦ J00.254.040.009	3.0	T15	J00.895.000.030	J00.895.002.015		J00.254.009.000
Type C54/D54.086.138.012						
④ J00.354.086.012						
⑤ J00.345.020.086						
⑥ J00.345.010.086						
⑦ J00.254.050.010	5.0	T20	J00.895.000.050	J00.895.002.020		J00.254.012.000
Type C54/D54.136.220.009						
④ J00.354.136.009						
⑤ J00.345.020.136						
⑥ J00.345.010.136						
⑦ J00.254.040.009	3.0	T15	J00.895.000.030	J00.895.002.015		J00.254.009.000
Type C54/D54.136.220.012						
④ J00.354.136.012						
⑤ J00.345.020.136						
⑥ J00.345.010.136						
⑦ J00.254.050.010	5.0	T20	J00.895.000.050	J00.895.002.020		J00.254.012.000
Type C54/D54.188.302.009						
④ J00.354.188.009						
⑤ J00.345.020.136						
⑥ J00.345.010.136						
⑦ J00.254.040.009	3.0	T15	J00.895.000.030	J00.895.002.015		J00.254.009.000
Type C54/D54.242.402.009						
④ J00.354.242.009						
⑤ J00.345.020.136						
⑥ J00.345.010.136						
⑦ J00.254.040.009	3.0	T15	J00.895.000.030	J00.895.002.015		J00.254.009.000

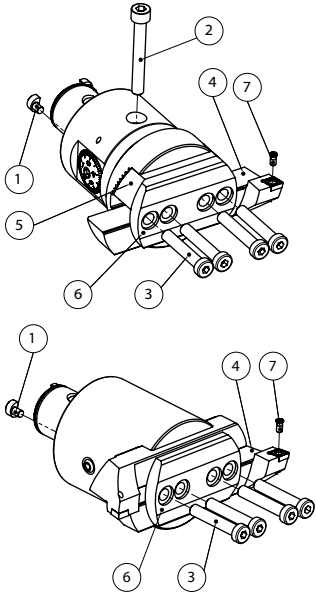

Ersatzteile / Zubehör

Spare parts / Accessories

D04

Type	max. Nm	S	Torque key	Bit	Service key
D04.020.024.045					

②	J00.404.004.008	2.4	2.5	J00.895.000.022	J00.895.001.025	J00.892.000.025
③	J00.405.004.000					
④	J00.406.025.008					

Type
D04.025.031.056

②	J00.404.005.012	5.0	3	J00.895.000.050	J00.895.001.030	J00.892.000.030
③	J00.405.005.000					
④	J00.406.025.008					

Type
D04.032.040.066

②	J00.404.006.016	9.0	4			J00.892.000.040
③	J00.405.006.000					
④	J00.406.030.012					

Type
D04.040.051.075

②	J00.404.008.020	20.0	5			J00.892.000.050
③	J00.405.008.000					
④	J00.406.030.014					

Type
D04.050.067.090

②	J00.404.010.025	35.0	6			J00.892.000.060
③	J00.405.010.000					
④	J00.406.040.020					

Type
D04.063.087.110

②	J00.404.012.025	35.0	8			J00.892.000.080
③	J00.405.012.000					
④	J00.406.060.020					

Type
D04.080.115.140



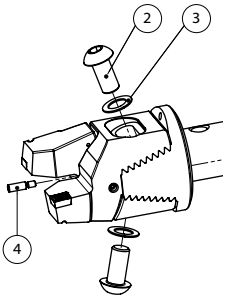

②	J00.404.016.035	35.0	10			J00.892.000.100
③	J00.405.016.000					
④	J00.406.060.020					



Ersatzteile / Zubehör

Spare parts / Accessories

D14/D24/D37



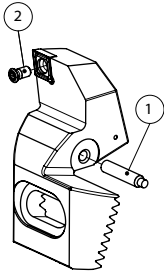

Type D14/D24/D37	max. Nm	S / Torx	Torque key 	Bit 	Service key 	Service key 
020.024.006						
① J00.414.004.007		2			J00.892.000.020	
② J00.254.025.006	0.9	T7	J00.895.000.009	J00.895.002.007		J00.254.007.000
Type D14/D24/D37 025.031.006						
① J00.414.004.010		2			J00.892.000.020	
② J00.254.025.006	0.9	T7	J00.895.000.009	J00.895.002.007		J00.254.007.000
Type D14/D24/D37 032.040.009						
① J00.414.004.013		2			J00.892.000.020	
② J00.254.040.009	3.0	T15	J00.895.000.030	J00.895.002.015		J00.254.009.000
Type D14/D24/D37 039.051.009						
① J00.414.006.014		3			J00.892.000.030	
② J00.254.040.009	3.0	T15	J00.895.000.030	J00.895.002.015		J00.254.009.000
Type D14/D24/D37 050.067.xxx						
① J00.415.006.020		3			J00.892.000.030	
② J00.254.050.010	5.0	T20	J00.895.000.050	J00.895.002.020		J00.254.012.000
Type D14/D24/D37 064.087.xxx						
① J00.415.006.020		3			J00.892.000.030	
② J00.254.050.010	5.0	T20	J00.895.000.050	J00.895.002.020		J00.254.012.000
Type D14/D24/D37 090.115.xxx						
① J00.415.006.020		3			J00.892.000.030	
② J00.254.050.010	5.0	T20	J00.895.000.050	J00.895.002.020		J00.254.012.000



Ersatzteile / Zubehör

Spare parts / Accessories

D14/D24

Type D14/D24.050.067.112	max. Nm	S	Torque key 	Bit 	Service key 	Service key 
③ J00.416.012.000						
④ J00.417.012.000						
⑤ J00.418.012.000						
⑥ J00.419.012.000		3			J00.892.000.030	
Type D14/D24.064.087.116						
③ J00.416.016.000						
④ J00.417.016.000						
⑤ J00.418.016.000						
⑥ J00.419.016.000		3			J00.892.000.030	
Type D14/D24.064.087.116						
③ J00.416.016.000						
④ J00.417.016.000						
⑤ J00.418.016.000						
⑥ J00.419.016.000		4			J00.892.000.040	

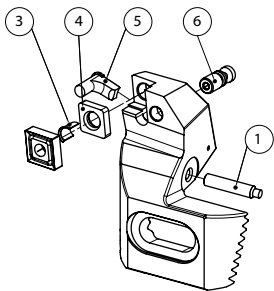

Ersatzteile / Zubehör

Spare parts / Accessories

D34

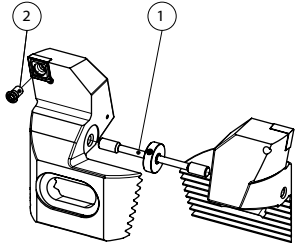

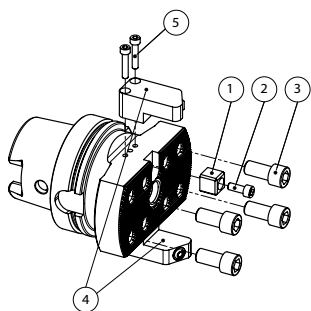

Type	max. Nm	S / Torx	Torque key	Bit	Service key	Service key
Type D34.020.024.006						
① J00.434.004.018		2			J00.892.000.020	
② J00.254.025.006	0.9	T7	J00.895.000.009	J00.895.002.007		J00.254.007.000
Type D34.025.031.006						
① J00.434.004.023		2			J00.892.000.020	
② J00.254.025.006	0.9	T7	J00.895.000.009	J00.895.002.007		J00.254.007.000
Type D34.032.040.009						
① J00.434.004.030		2			J00.892.000.020	
② J00.254.040.009	3.0	T15	J00.895.000.030	J00.895.002.015		J00.254.009.000
Type D34.039.051.009						
① J00.434.006.040		3			J00.892.000.030	
② J00.254.040.009	3.0	T15	J00.895.000.030	J00.895.002.015		J00.254.009.000
Type D34.050.067.012						
① J00.434.006.052		3			J00.892.000.030	
② J00.254.050.010	5.0	T20	J00.895.000.050	J00.895.002.020		J00.254.012.000
Type D34.064.087.012						
① J00.434.006.068		3			J00.892.000.030	
② J00.254.050.010	5.0	T20	J00.895.000.050	J00.895.002.020		J00.254.012.000
Type D34.090.115.012						
① J00.434.006.090		3			J00.892.000.030	
② J00.254.050.010	5.0	T20	J00.895.000.050	J00.895.002.020		J00.254.012.000



Ersatzteile / Zubehör

Spare parts / Accessories

E04/E14/E34/E44/E54

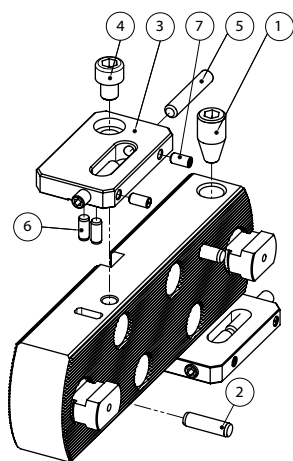

Type E04/E14/E34/E44/E54	max. Nm	S	Torque key 	Bit 	Service key 
① J00.514.016.016					
② J00.515.006.015	8	5			J00.892.000.050
③ J00.516.012.025	60	10			J00.892.000.100
④ J00.500.028.015					
⑤ J00.500.005.025	5	4			J00.892.000.040



Ersatzteile / Zubehör

Spare parts / Accessories

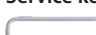

E60/E62/E64

Type E60/E64	max. Nm	S / Torx	Torque key 	Bit 	Service key 
① J00.560.016.030	50.0	8			J00.892.000.080
② J00.560.008.028					
⑦ J00.560.006.012					
Type E60.130.130/230.030					
③ J00.560.080.012					
④ J00.560.110.012	35.0	8			J00.892.000.080
⑤ J00.560.008.045		4			J00.892.000.040
⑥ J00.560.006.014					
Type E64.000.xxx.048 E60.130.180/280-580. xxx					
③ J00.560.080.012					
④ J00.560.110.018	35.0	8			J00.892.000.080
⑤ J00.560.008.045		4			J00.892.000.040
⑥ J00.560.006.014					

Ersatzteile / Zubehör

Spare parts / Accessories

E70/E80

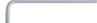

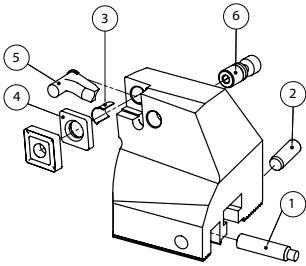
Type E70/E80	max. Nm	S / Torx	Torque key 	Bit 	Service key 
① J00.570.008.035		4			J00.892.000.040
② J00.570.008.024					
Type E70.070.012.075					
③ J00.416.012.000					
④ J00.417.012.000					
⑤ J00.418.012.000					
⑥ J00.419.012.000		3			J00.892.000.030
Type E70/E80.070.012.075					
③ J00.416.019.000					
④ J00.417.019.000					
⑤ J00.418.019.000					
⑥ J00.419.019.000		3			J00.892.000.030



Ersatzteile / Zubehör

Spare parts / Accessories

E90/E91/E94



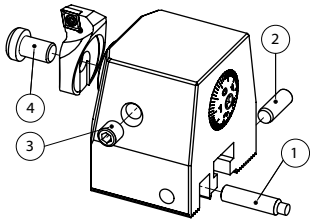

Type E90/E91.070.030.075	max. Nm	S / Torx	Torque key 	Bit 	Service key 
① J00.570.008.035		4			J00.892.000.040
② J00.570.008.024					
③ J00.590.010.020	8	5	J00.895.000.057	J00.895.001.050	J00.892.000.050
④ J00.314.010.016	35.0	8			J00.892.000.080
Type E94.070.065.072					
① J00.570.008.035		4			J00.892.000.040
② J00.570.008.024					



Ersatzteile / Zubehör

Spare parts / Accessories

E98

Type E98.040.070.009	max. Nm	S / Torx	Torque key 	Bit 	Service key 	Service key 
③ J00.726.004.010	4.5	3	J00.895.000.042	J00.895.001.030	J00.892.000.030	
④ J00.726.004.025	4.5	3	J00.895.000.042	J00.895.001.030	J00.892.000.030	
⑤ J00.254.025.006	0.9	T7	J00.895.000.009	J00.895.002.007		J00.254.007.000
⑥ J00.598.005.008	1.2	2.5	J00.895.000.010	J00.895.001.025	J00.892.000.025	

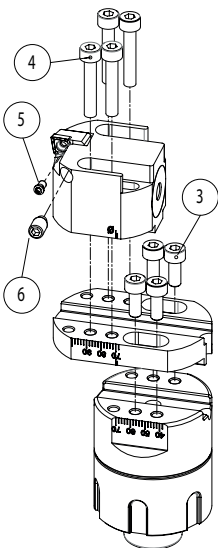



Torque key	Nm
J00.895.000.006	0.6
J00.895.000.009	0.9
J00.895.000.010	1.0
J00.895.000.012	1.2
J00.895.000.018	1.8
J00.895.000.022	2.2
J00.895.000.030	3.0
J00.895.000.038	3.8
J00.895.000.042	4.2
J00.895.000.050	5.0
J00.895.000.057	5.7



Service key set	S
J00.892.015.080	1.5 - 8
J00.892.015.100	1.5-10



Service key	S
J00.892.000.015	1.5
J00.892.000.020	2
J00.892.000.025	2.5
J00.892.000.030	3
J00.892.000.040	4
J00.892.000.050	5
J00.892.000.060	6
J00.892.000.080	8
J00.892.000.100	10
J00.892.000.120	12
J00.892.000.140	14



Torx bit	Tx
J00.895.002.005	5
J00.895.002.006	6
J00.895.002.007	7
J00.895.002.008	8
J00.895.002.009	9
J00.895.002.010	10
J00.895.002.015	15
J00.895.002.020	20



Hexagon bit	S
J00.895.001.015	1.5
J00.895.001.020	2
J00.895.001.025	2.5
J00.895.001.030	3
J00.895.001.040	4
J00.895.001.050	5
J00.895.001.060	6
J00.895.001.080	8



Torx key	Tx
J00.254.006.000	6
J00.254.007.000	7
J00.254.009.000	15
J00.254.012.000	20

Dimensionen

Dimensions

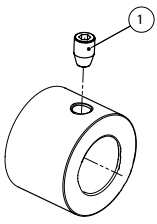

WH	Klemmschraube / Clamping screw ①	D	d1	L	M	Anzugsdrehmoment / Torque	Hex size
WH1	J00.100.005.008	20	11	13	M5x0.5	3.5Nm	2.5
WH2	J00.100.008.008	25	14	18	M8x1	12Nm	4
WH3	J00.100.008.010	32	18	22	M8x1	12Nm	4
WH4	J00.100.010.015	40	22	28	M10x1	22Nm	5
WH5	J00.100.012.017	50	28	28	M12x1	25Nm	6
WH6	J00.100.016.021	63	36	40	M16x1.5	30Nm	8
WH8	J00.100.016.029	80	36	40	M16x1.5	30Nm	8

INSTRUCTION MANUAL
Ø 0.3 - 19.1 mm



assembling boring bar

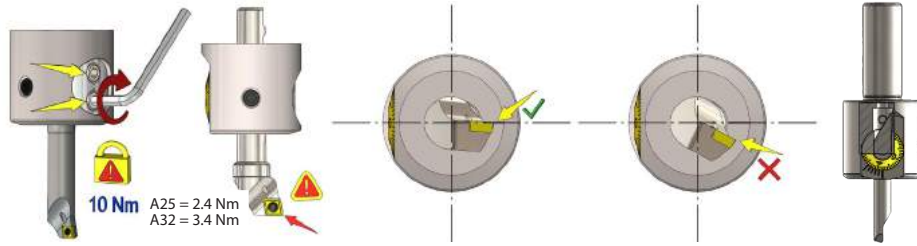

diameter adjustment

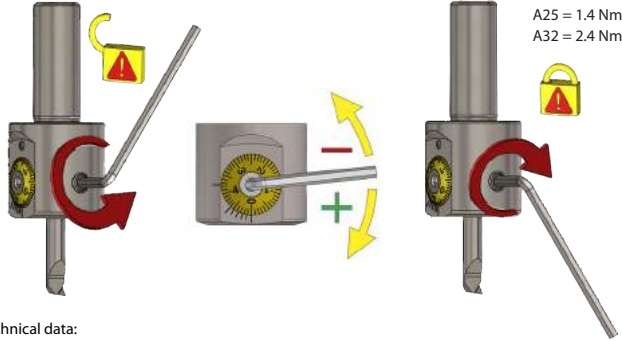

scale / vernier

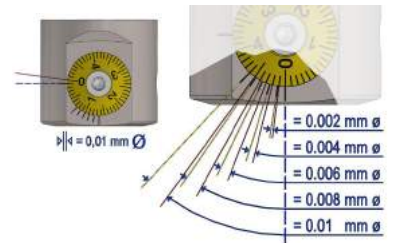

Technical data:

Boring range: A25 Ø 0.3 - 7.1 mm
 A32 Ø 0.3 - 19.1 mm

Tool holder bore: A25 Ø 4.0 mm
 A32 Ø 7.0 mm

Max. Spindle speed: 30.000 rpm

Adjustment range: A25 -0.1 / + 3.0 mm Ø
 A32 -0.1 / + 5.0 mm Ø

INSTRUCTION MANUAL
Ø 3.0 - 88.1 mm



assembling boring bar

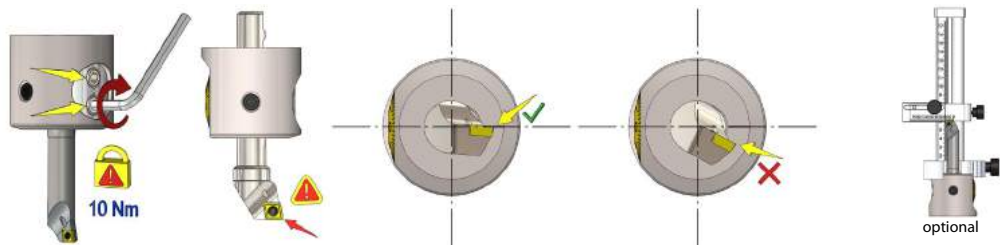

diameter adjustment

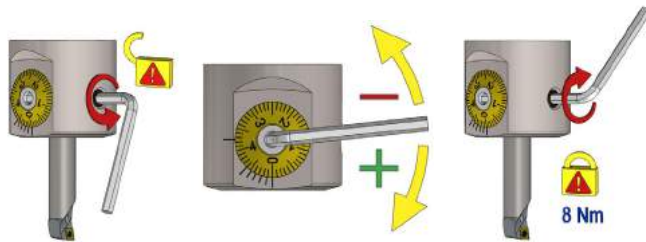

scale / vernier

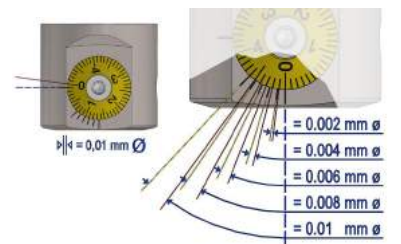

Max. revolution

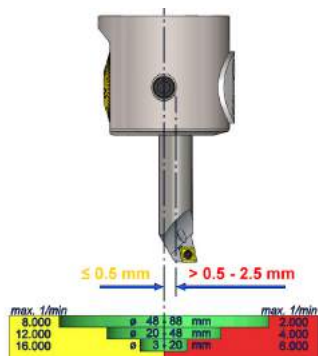

INSTRUCTION MANUAL
Multi-Head Ø 3-320 mm



assembling boring bar

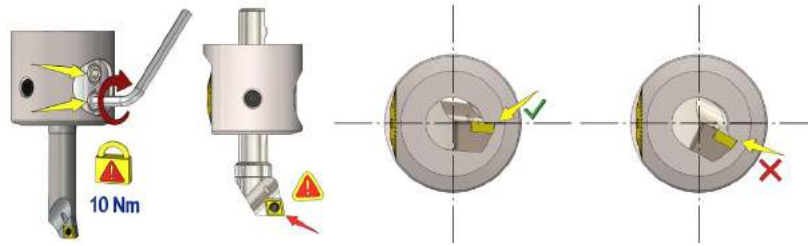

diameter adjustment

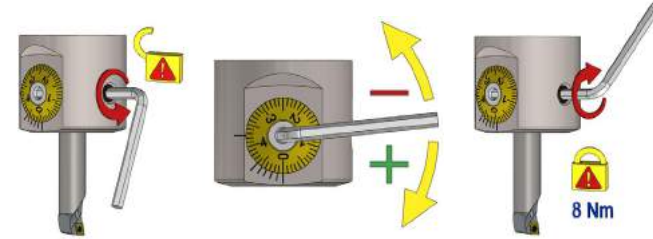

scale / vernier

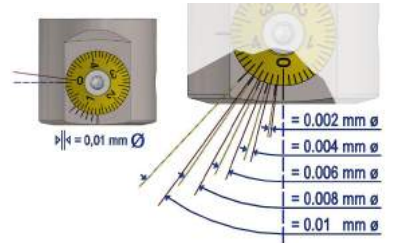

optional

Max. revolution

max. 1/min	≤ 0.5 mm	> 0.5 - 2.5 mm	max. 1/min
8.000	48.98 mm	2.000	4.000
12.000	20.148 mm	4.000	8.000
16.000	3.20 mm	8.000	16.000

Vmax 450 m/min (Ø88.0 - 164.0)
Vmax 250 m/min (Ø164.0 - 320.0)

assembling Ø86-320mm

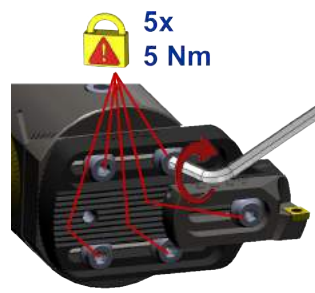

presetting scale

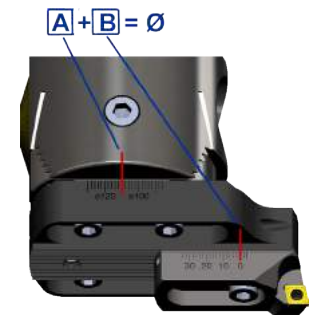

INSTRUCTION MANUAL
VARIO HEAD Ø 3 - 152 mm



assembling boring bar

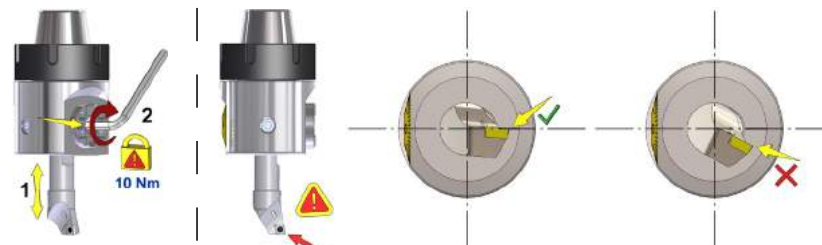

assembling coolant plug



assembling insertholder

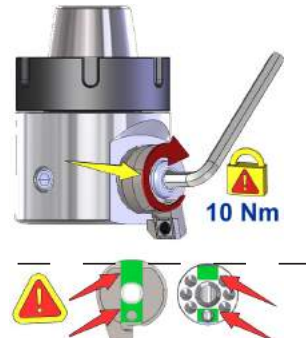

scale / vernier

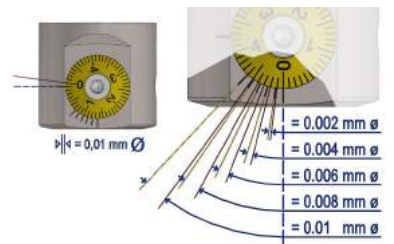

optional

diameter adjustment

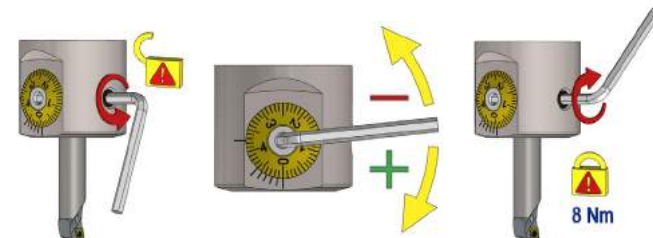

back boring

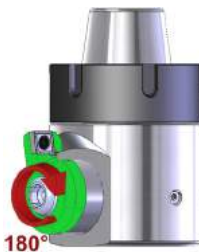

FINE BORING HEAD
Ø 24 - 171 mm

assembling boring head

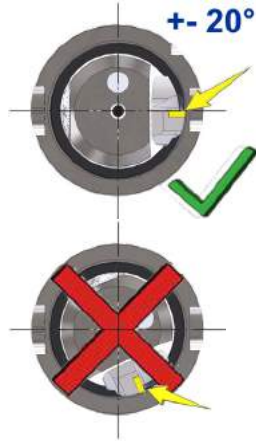

assembling insertholder

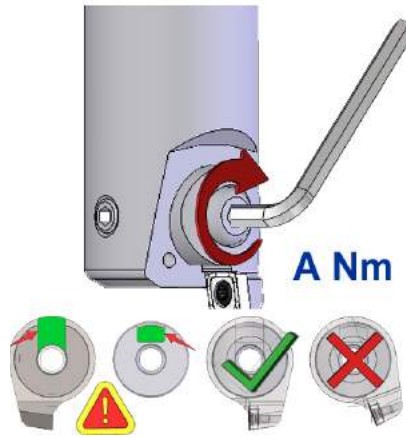

back boring (requires a reversal adapter)



diameter adjustment

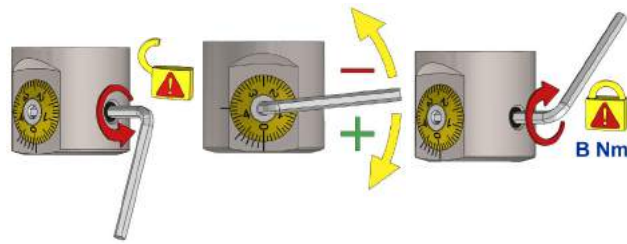

scale / vernier

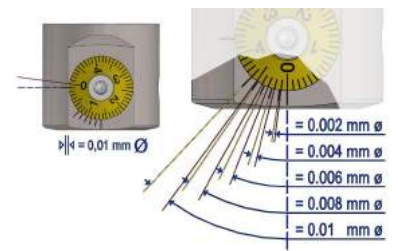

Fine boring head	Nm A	Nm B	max. rpm balanced	max. rpm unbalanced
D20 / Ø 24-31	2.4	1.2	12,000	9,000
D25 / Ø 31-40	3.4	1.4	10,000	7,500
D32 / Ø 40-51	5.0	2.4	8,000	5,250
D42 / Ø 51-67	10	4.0	6,500	4,000
D55 / Ø 67-87	20	8	5,000	3,000
D72 / Ø 87-116	20	8	4,000	2,500
D94 / Ø 116 - 171	20	8	3,000	1,750

INSTRUCTION MANUAL
Fine + Rough boring head
Ø 86 - 402 mm

assembling

Ø86 - 138
2x 25Nm
 < Ø136
4x 25Nm

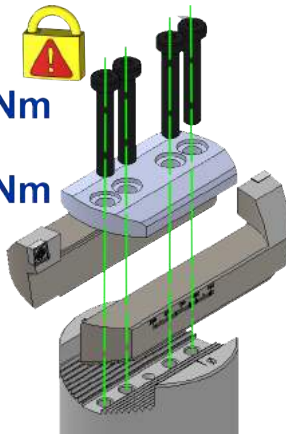

pre adjustment / coolant

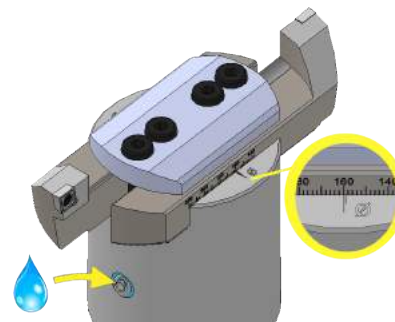

adjustment fine boring

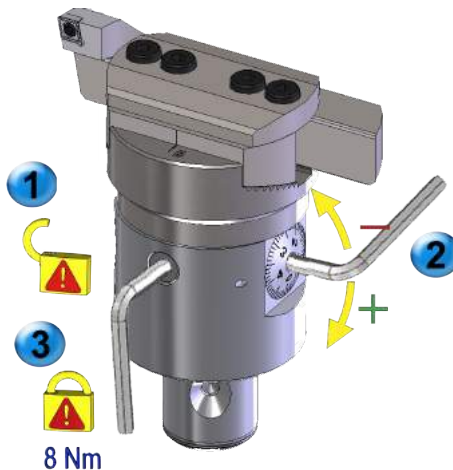

scale / vernier

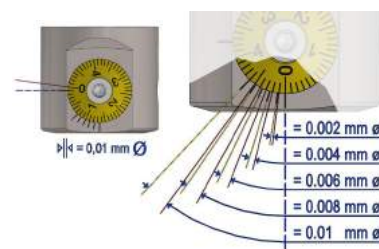

Digital display unit

Function / maintenance

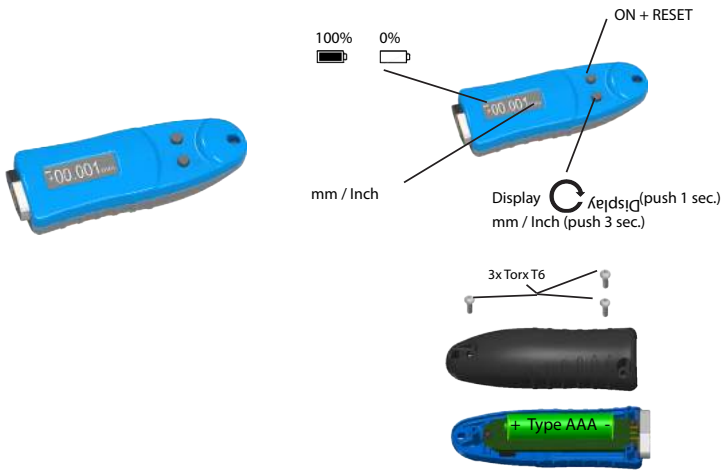

Handling

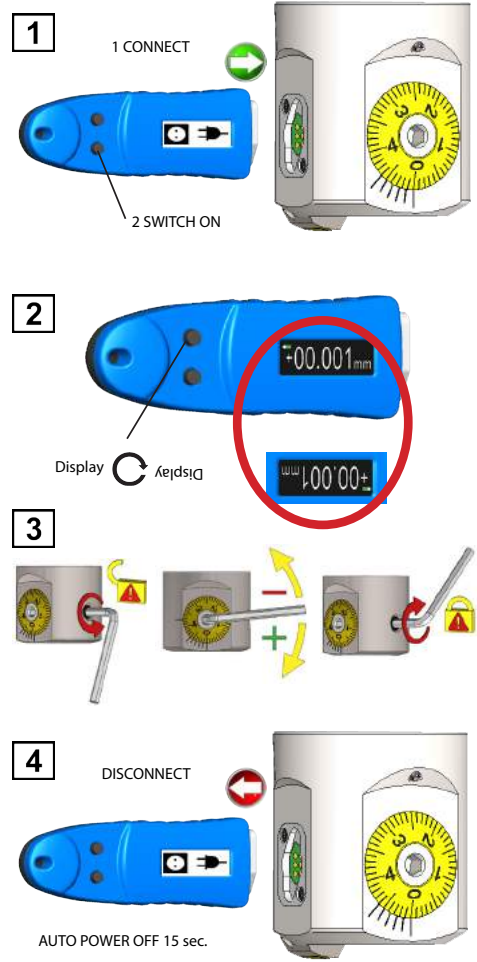

assembling boring bar



ø A min.	ø A max.	D	L	L1	Wendeplatte / Insert	M	SW	Nm
8.75	14.1	8	56	91	CC...06 02..	5	7	6
9.75	15.1	9	63	98	CC...06 02..	5	8	6
10.75	16.1	10	70	105	CC...06 02..	6	8	9
11.75	17.1	11	77	112	CC...06 02..	6	9	9
12.75	18.1	12	84	119	CC...06 02..	6	10	9
13.75	19.1	13	91	126	CC...06 02..	6	11	9
14.75	20.1	14	98	133	CC...06 02..	6	12	9
15.75	21.1	14	98	133	CC...06 02..	6	12	9
16.75	22.1	16	112	147	CC...06 02..	10	14	20
17.75	23.1	16	112	147	CC...06 02..	10	14	20
19.75	25.1	16	112	147	CC...06 02..	10	14	20
21.75	27.1	16	112	147	CC...06 02..	10	14	20
24.75	30.1	16	112	147	CC...06 02..	10	14	20
27.75	33.1	16	112	147	CC...06 02..	10	14	20
31.75	37.1	16	112	147	CC...06 02..	10	14	20
34.75	40.1	16	112	147	CC...06 02..	10	14	20

ROUGH BORING HEAD
Ø 23 - 153 mm

assembling insertholder
synchronous adjustment

single adjustment

torque / revolution

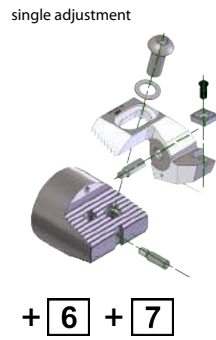
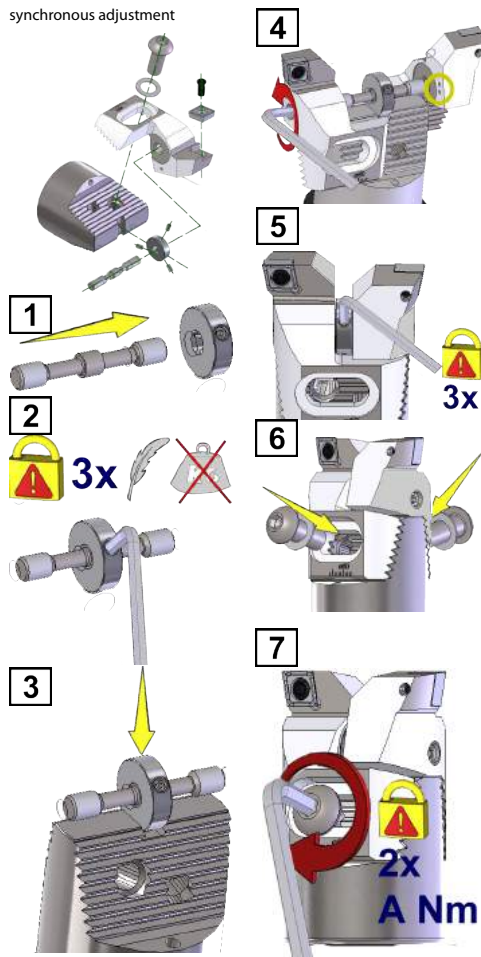

Rough boring head	Nm A	max. rpm
D20 / Ø 23-31	2.4	12.000
D25 / Ø 31-40	5	10.000
D32 / Ø 40-51	9	8.000
D42 / Ø 51-67	20	6.500
D55 / Ø 67-87	35	5.000
D72 / Ø 87-116	35	4.000
D94 / Ø 116 - 153	35	3.000

diameter adjustment

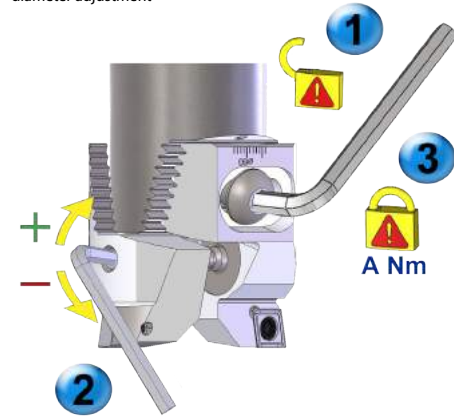

INSTRUCTION MANUAL
BRIDGE TOOLS Ø 150 - 655 mm

assembling

revolution

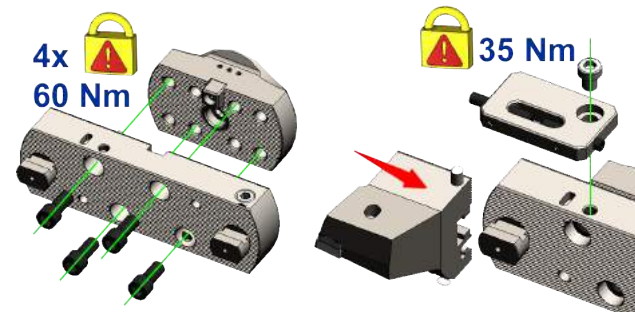

diameter	max. rpm
Ø150-205	1.250
Ø200-255	1.000
Ø250-305	850
Ø300-355	700
Ø350-405	600
Ø400-455	530
Ø450-505	480
Ø500-555	440
Ø550-605	400
Ø600-655	360

pre adjustment

scale / vernier

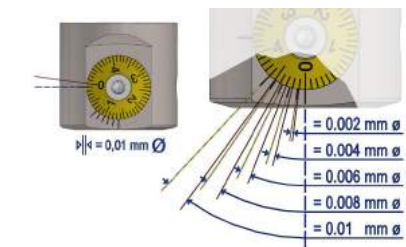
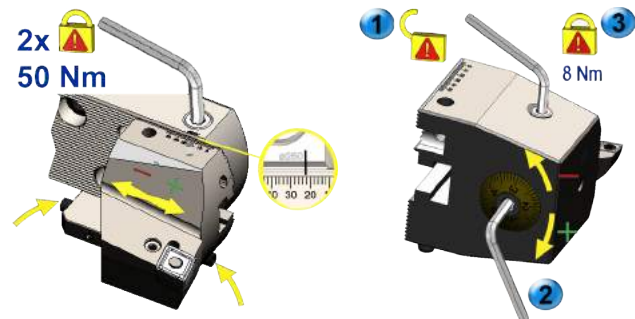

pin turning

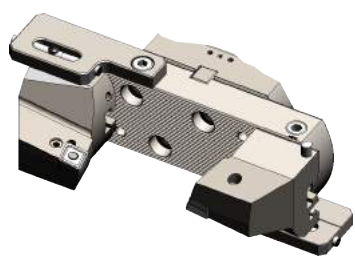

INSTRUCTION MANUAL
ECO HEAD Ø 39.9 - 100.1 mm

assembling rough adjustment Ø 39.9 - 70.1mm

assembling rough adjustment Ø 69.9 - 100.1mm

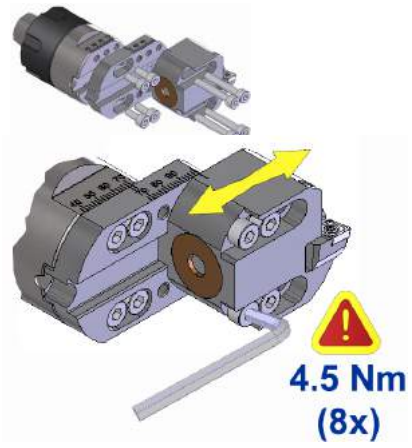
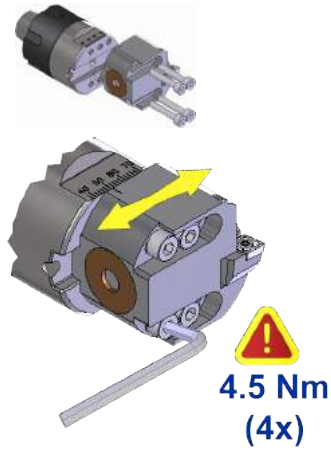

diameter fine adjustment

scale / vernier

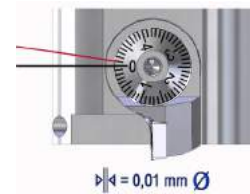
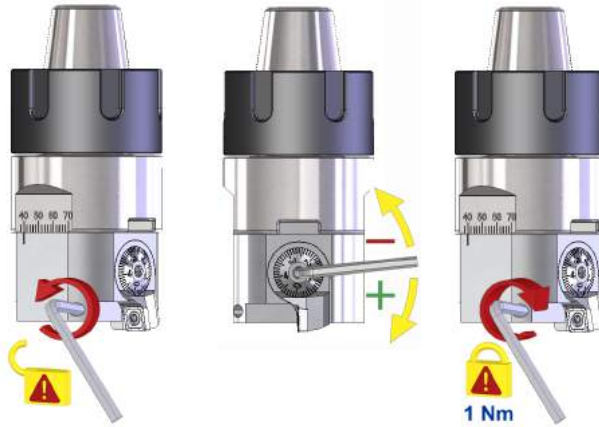

maximum spindle speed

$V_{max} = 450 \text{ m/min } (\varnothing 40-70)$
 $V_{max} = 250 \text{ m/min } (\varnothing 70-100)$

Balancing ring

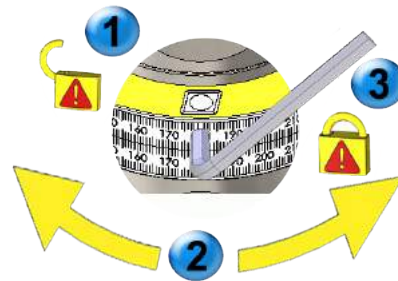
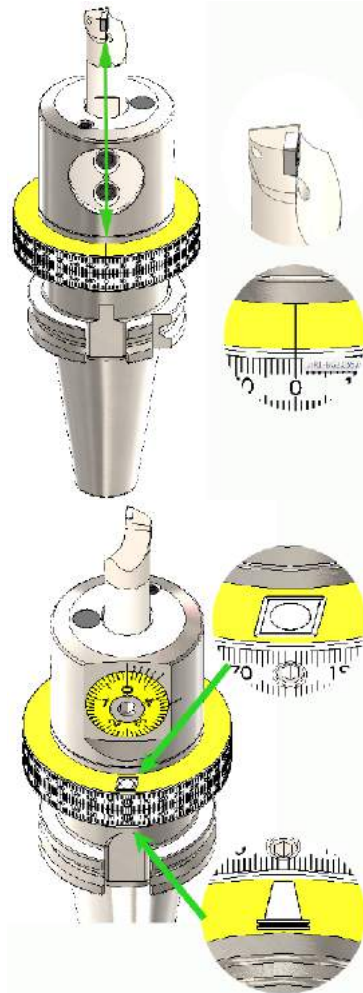
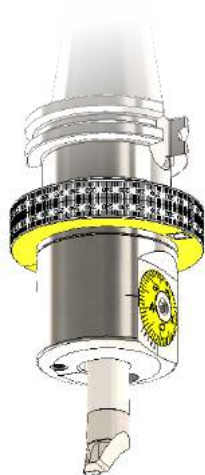

Auswuchttabelle / balancing chart

Ausdrehkopf / fine boring head		Einstellwert am Auswuchtring / presetting value on the balancing ring											
Bestellnummer / order number													
262.550.045													
Ausdrehstahl / boring bar													
Bestellnummer / order number		\varnothing	\varnothing	\varnothing	\varnothing	\varnothing	\varnothing	\varnothing	\varnothing	\varnothing	\varnothing	\varnothing	\varnothing
272.010.006		10	103	284	11	81	290	12	84	291	13		
272.012.006		12	104	295	13	81	291	14	84	292	15		
272.014.006		14	104	295	15	81	291	16	83	292	17		
272.015.008		15	105	297	16	82	292	17	83	293	18		
272.016.006		16	107	299	17	82	293	18	83	294	19		
272.018.006		18	108	301	19	83	294	20	83	295	21		

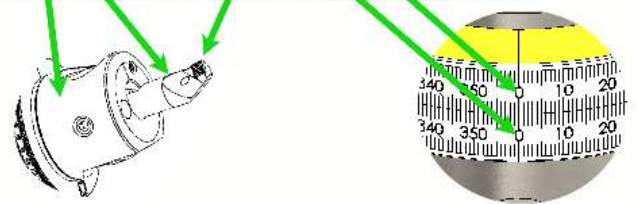

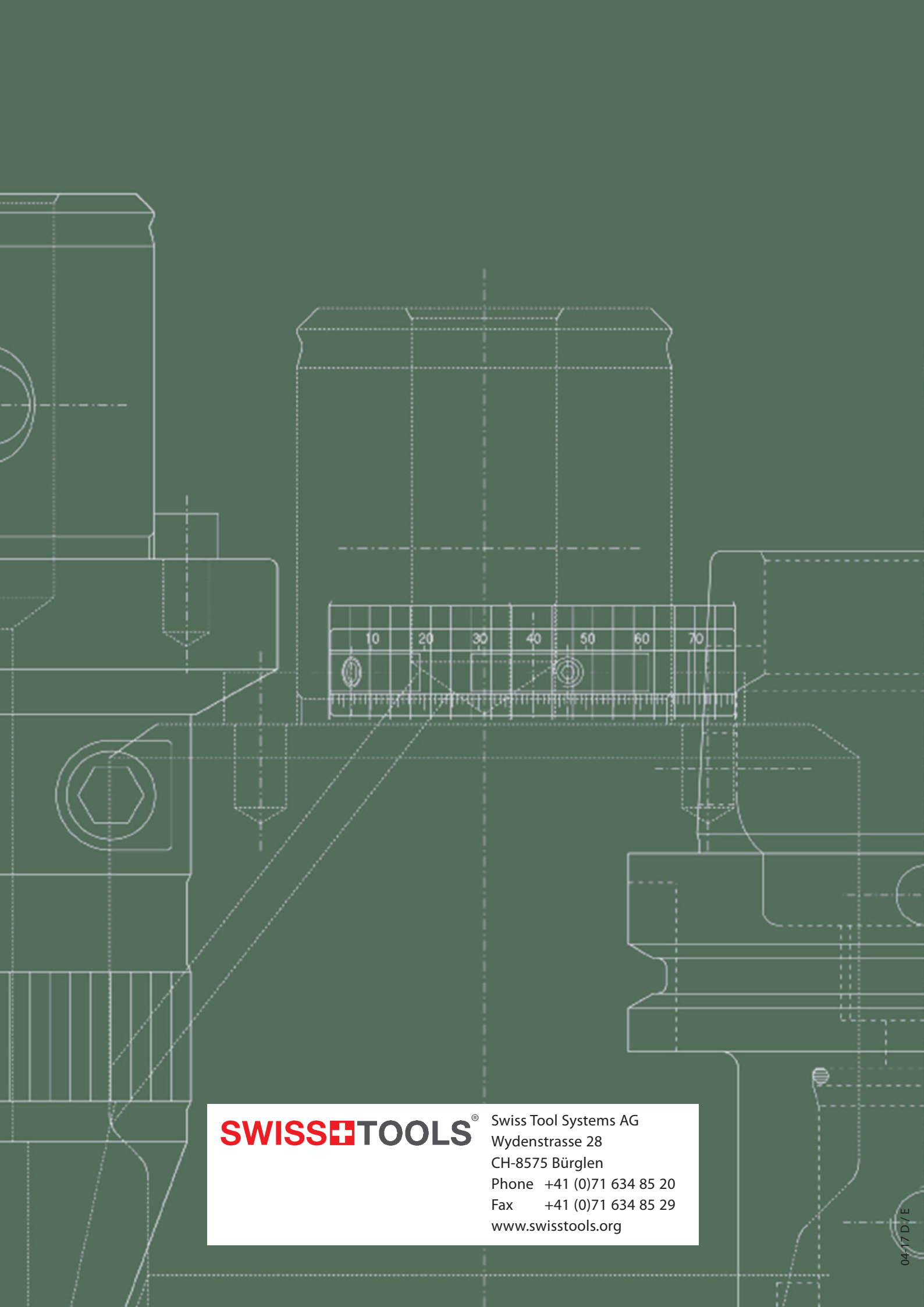

SWISS+TOOLS[®] Swiss Tool Systems AG
Wydenstrasse 28
CH-8575 Bürglen
Phone +41 (0)71 634 85 20
Fax +41 (0)71 634 85 29
www.swisstools.org