

Pinces - Spannzangen - Collets ESX, EX

ESX (DIN 6499-B)

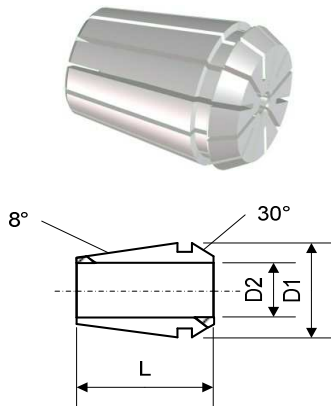

qualité standard
 Qualität Standard
 quality standard

avec plage de serrage (S) vers le bas
 mit Spannbereich (S) nach unten
 with compression (S) inwards

EX (DIN 6499-A)

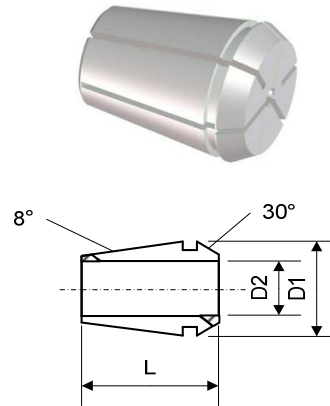

qualité UP
 Qualität UP
 quality UP

serre le diamètre nominal
 spannt den Nenndurchmesser
 clamps the nominal diameter

| Gr. | Art. | D1 | D2 | L | S | Gr. | Art. | D1 | D2 | L |
|------------|----------|----|---------------|------|----------|------------|----------|-------|--------|------|
| ESX9 | 75-9300 | 9 | 1-5 | 14.5 | 0.5 | EX9 | 75-9200 | 9 | 0.5-5 | 14.5 |
| ESX12 | 75-12300 | 12 | 1-3 4-7 | 19.5 | 0.5 1 | EX12 | 75-12200 | 11.75 | 0.5-7 | 17.5 |
| ESX16 | 75-16300 | 17 | 1-1.5 2-10 | 27.5 | 0.5 1 | EX16 | 75-16200 | 16.7 | 0.3-10 | 27.5 |
| DIN 6499-B | | | | | | DIN 6499-A | | | | |
| ESX20 | 75-20300 | 21 | 1-1.5 2-13 | 31.5 | 0.5 1 | EX20 | 75-20200 | 20.7 | 1-13 | 31.5 |
| DIN 6499-B | | | | | | DIN 6499-A | | | | |
| ESX25 | 75-25300 | 26 | 1-1.5 2-16 | 34 | 0.5 1 | EX25 | 75-25200 | 25.7 | 1-16 | 34 |
| DIN 6499-B | | | | | | DIN 6499-A | | | | |
| ESX32 | 75-32300 | 33 | 2.5 3-20 | 40 | 0.5 1 | EX32 | 75-32200 | 32.7 | 2-20 | 40 |
| DIN 6499-B | | | | | | DIN 6499-A | | | | |
| ESX40 | 75-40300 | 41 | 3-26 | 46 | 1 | EX40 | 75-40200 | 40.7 | 3-26 | 46 |
| DIN 6499-B | | | | | | DIN 6499-A | | | | |